

DATE	REMARKS
04-11-2018	SITE PLAN AMENDMENT
08-28-2016	2ND PLANNING SUBMITTAL
09-20-2016	PRELIM. DRAINAGE RESUBMITTAL
10-27-2016	3RD PLANNING SUBMITTAL
11-16-2016	4TH PLANNING SUBMITTAL
12-21-2016	PRELIM. DRAINAGE RESUBMITTAL
01-18-2017	MT/LAR SET
02-24-2017	MONUMENT SIGN REVISION

PA / PM:	RJK
DRAWN BY:	AEDG
JOB NO.:	DEN16-0016-00

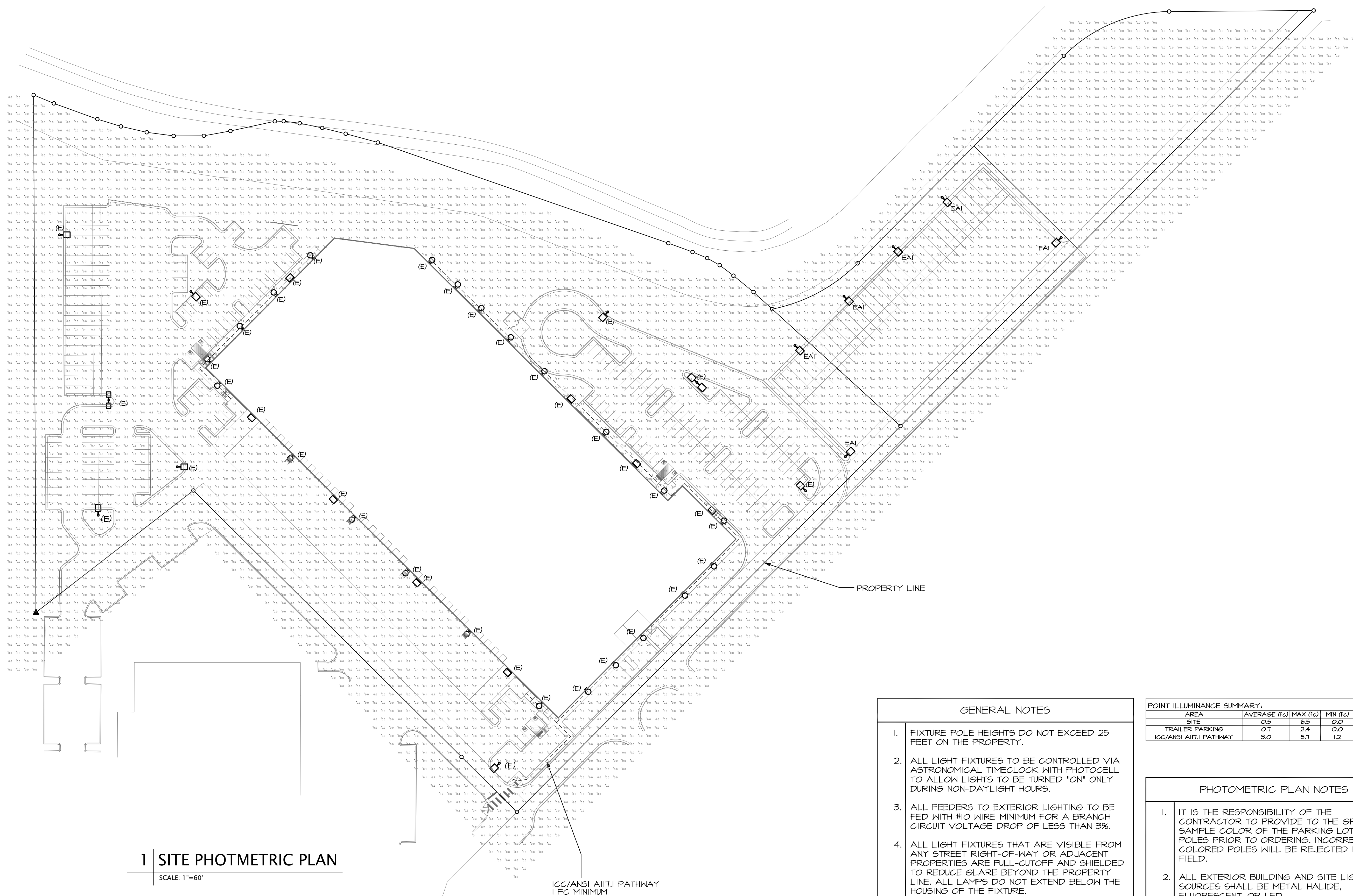

1 | SITE PHOTOMETRIC PLAN
SCALE: 1"=60'

GENERAL NOTES

1. FIXTURE POLE HEIGHTS DO NOT EXCEED 25 FEET ON THE PROPERTY.
2. ALL LIGHT FIXTURES TO BE CONTROLLED VIA ASTRONOMICAL TIMECLOCK WITH PHOTOCCELL TO ALLOW LIGHTS TO BE TURNED "ON" ONLY DURING NON-DAYLIGHT HOURS.
3. ALL FEEDERS TO EXTERIOR LIGHTING TO BE FED WITH #10 WIRE MINIMUM FOR A BRANCH CIRCUIT VOLTAGE DROP OF LESS THAN 3%.
4. ALL LIGHT FIXTURES THAT ARE VISIBLE FROM ANY STREET RIGHT-OF-WAY OR ADJACENT PROPERTIES ARE FULL-CUTOFF AND SHIELDED TO REDUCE GLARE BEYOND THE PROPERTY LINE. ALL LAMPS DO NOT EXTEND BELOW THE HOUSING OF THE FIXTURE.
5. ILLUMINATION WITHIN THE SITE MUST COMPLY WITH THE 2015 INTERNATIONAL BUILDING CODE REQUIREMENT FROM SECTION 1006 - MEANS OF EGRESS ILLUMINATION. SECTION 1006. ILLUMINATION REQUIRED: THE MEANS OF EGRESS, INCLUDING THE EXIT DISCHARGE, SHALL BE ILLUMINATED AT ALL TIMES THE BUILDING IS OCCUPIED. SECTION 1006.2 ILLUMINATION LEVEL. THE MEANS OF EGRESS ILLUMINATION SHALL NOT BE LESS THAN 1 FOOT-CANDLE (1 LUX) AT THE FLOOR LEVEL, AND CONTINUING TO THE "PUBLIC WAY".

POINT ILLUMINANCE SUMMARY:

AREA	AVERAGE (fc)	MAX (fc)	MIN (fc)	MAX:MIN	AVG:MIN
SITE	0.5	6.5	0.0	N/A	N/A
TRAILER PARKING	0.1	2.4	0.0	N/A	N/A
IGC/ANSI A11.1 PATHWAY	3.0	9.1	1.2	4.4:1	2.4:1

PHOTOMETRIC PLAN NOTES

1. IT IS THE RESPONSIBILITY OF THE CONTRACTOR TO PROVIDE TO THE GPDRG A SAMPLE COLOR OF THE PARKING LOT LIGHT POLES PRIOR TO ORDERING. INCORRECT COLORED POLES WILL BE REJECTED IN THE FIELD.
2. ALL EXTERIOR BUILDING AND SITE LIGHT SOURCES SHALL BE METAL HALIDE, FLUORESCENT, OR LED.
3. PARKING LOT LIGHT POLES INCLUDING BOLT COVERS, BASES (28" MAXIMUM HEIGHT), ETC. SHALL BE PAINTED A MATCH OF RAL6012 DENVER FEDERAL GREEN. THE STANDARD GPDRG LIGHT POLE EXHIBIT MUST BE PLACED ON THE SITE PLAN AND CONSTRUCTION DRAWINGS.

SCALE: NONE