

REDEVELOPMENT PLAN

FOR

3576 NORTH MOLINE STREET

AURORA, COLORADO

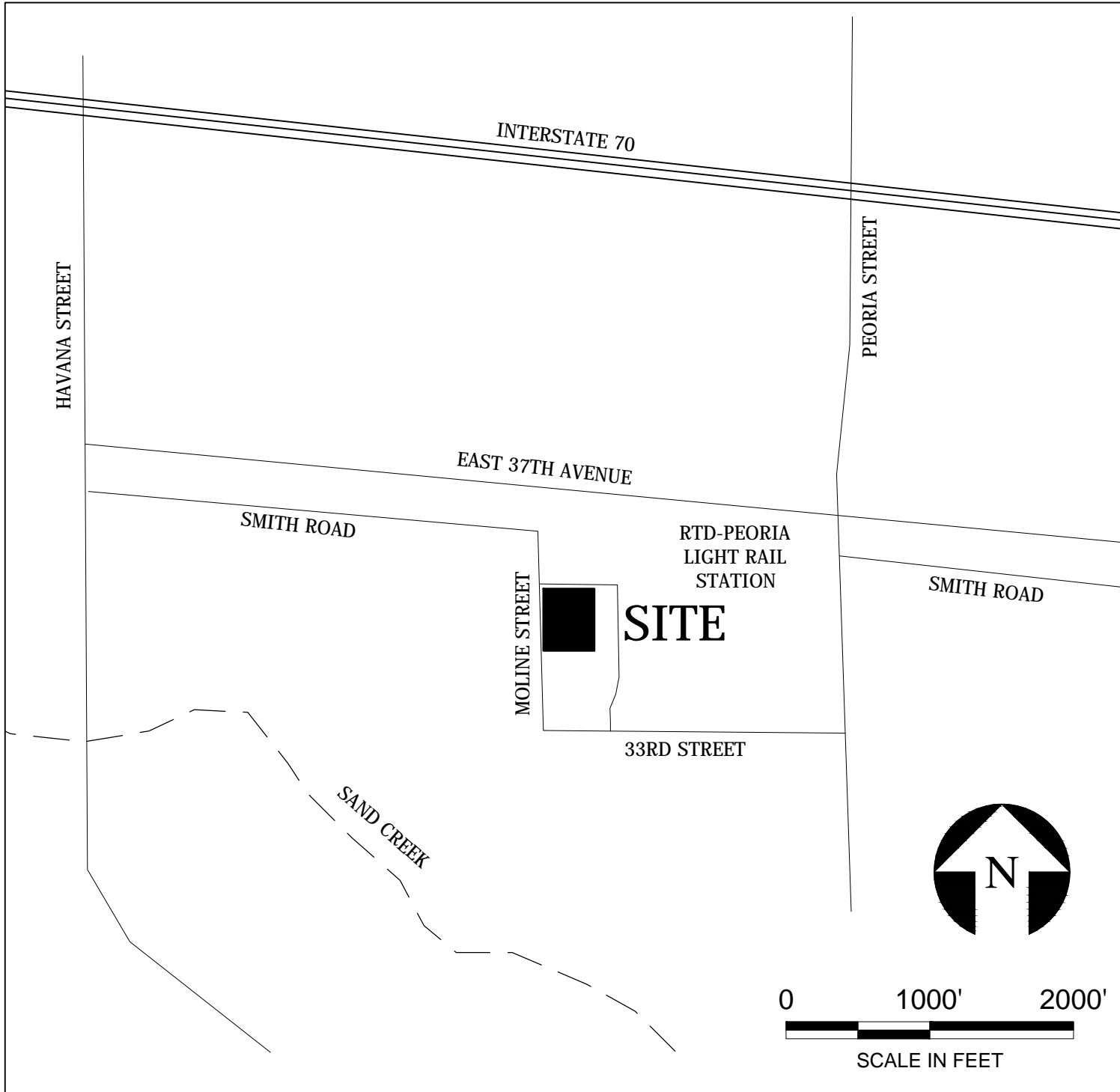

VICINITY MAP

REQUIRED SITE PLAN NOTES

1. THE DEVELOPER, HIS SUCCESSORS AND ASSIGNS, INCLUDING THE HOMEOWNERS OR MERCHANTS ASSOCIATION, SHALL BE RESPONSIBLE FOR INSTALLATION, MAINTENANCE AND REPLACEMENT OF ALL FIRE LANE SIGNS AS REQUIRED BY THE CITY OF AURORA.
2. ALL SIGNS MUST CONFORM TO THE CITY OF AURORA SIGN CODE.
3. RIGHT OF WAY FOR INGRESS AND EGRESS FOR SERVICE AND EMERGENCY VEHICLES IS GRANTED OVER, ACROSS, ON AND THROUGH ANY AND ALL PRIVATE ROADS AND WAYS NOW OR HEREAFTER ESTABLISHED ON THE DESCRIBED PROPERTY, AND THE SAME ARE HEREBY DESIGNATED AS "SERVICE/EMERGENCY AND UTILITY EASEMENTS" AND SHALL BE POSTED "NO PARKING - FIRE LANE."
4. ACCESSIBILITY NOTE FOR COMMERCIAL PROJECTS BUILT UNDER THE 2009 IBC:
"ACCESSIBLE EXTERIOR ROUTES" SHALL BE PROVIDED FROM PUBLIC TRANSPORTATION STOPS, ACCESSIBLE PARKING AND ACCESSIBLE PASSENGER LOADING ZONES AND PUBLIC SIDEWALKS TO 60% OF THE ACCESSIBLE BUILDING ENTRANCE THEY SERVE. THE ACCESSIBLE ROUTE BETWEEN ACCESSIBLE PARKING AND ACCESSIBLE BUILDING ENTRANCES SHALL BE THE MOST PRACTICAL DIRECT ROUTE. THE ACCESSIBLE ROUTE MUST BE LOCATED WITHIN A SIDEWALK. NO SLOPE ALONG THIS ROUTE MAY EXCEED 1:20 WITHOUT PROVIDING A RAMP WITH A MAXIMUM SLOPE OF 1:12 AND HANDRAILS. CROSSWALKS ALONG THIS ROUTE SHALL BE WIDE ENOUGH TO WHOLLY CONTAIN THE CURB RAMP WITH A MINIMUM WIDTH OF 36" AND SHALL BE PAINTED WITH WHITE STRIPES. THE CITY OF AURORA ENFORCES HANDICAPPED ACCESSIBILITY REQUIREMENTS
5. THE APPLICANT HAS THE OBLIGATION TO COMPLY WITH ALL APPLICABLE REQUIREMENTS OF THE AMERICANS WITH DISABILITIES ACT.
6. THE DEVELOPER, HIS SUCCESSORS AND ASSIGNS, SHALL BE RESPONSIBLE FOR INSTALLATION, MAINTENANCE AND REPLACEMENT OF ALL LANDSCAPING MATERIALS SHOWN OR INDICATED ON THE APPROVED SITE PLAN OR LANDSCAPE PLAN ON FILE IN THE PLANNING DEPARTMENT. ALL LANDSCAPING WILL BE INSTALLED PRIOR TO ISSUANCE OF CERTIFICATE OF OCCUPANCY.
7. ALL CROSSINGS OR ENCROACHMENTS BY PRIVATE LANDSCAPE IRRIGATION SYSTEMS OR PRIVATE UTILITIES INTO EASEMENTS AND STREET RIGHTS-OF-WAY OWNED BY THE CITY OF AURORA ARE ACKNOWLEDGED BY THE UNDERSIGNED AS BEING SUBJECT TO CITY OF AURORA'S USE AND OCCUPANCY OF THE SAID EASEMENTS OR RIGHTS-OF-WAY. THE UNDERSIGNED, THEIR SUCCESSORS AND ASSIGNS, HEREBY AGREE TO INDEMNIFY THE CITY OF AURORA FOR ANY LOSS, DAMAGE OR REPAIR TO CITY FACILITIES THAT MAY RESULT FROM THE INSTALLATION, OPERATION OR MAINTENANCE OF SAID PRIVATE IRRIGATION LINES OR SYSTEMS AND/OR PRIVATE UTILITIES.
8. THE APPROVAL OF THIS DOCUMENT DOES NOT CONSTITUTE FINAL APPROVAL OF GRADING, DRAINAGE, UTILITY, PUBLIC IMPROVEMENTS AND BUILDING PLANS. CONSTRUCTION PLANS MUST BE REVIEWED AND APPROVED BY THE APPROPRIATE AGENCY PRIOR TO THE ISSUANCE OF BUILDING PERMITS.
9. ALL BUILDING ADDRESS NUMBERS SHALL COMPLY WITH SECTIONS 126-271 AND 126-278 OF THE AURORA CITY CODE.
10. ALL ROOFTOP MECHANICAL EQUIPMENT AND VENTS GREATER THAN EIGHT (8) INCHES IN DIAMETER MUST BE SCREENED. SCREENING MAY BE DONE EITHER WITH AN EXTENDED PARAPET WALL OR A FREESTANDING SCREEN WALL. SCREENS SHALL BE AT LEAST AS HIGH AS THE EQUIPMENT THEY HIDE. IF EQUIPMENT IS VISIBLE BECAUSE SCREENS DON'T MEET THIS MINIMUM HEIGHT REQUIREMENT, THE DIRECTOR OF PLANNING MAY REQUIRE CONSTRUCTION MODIFICATIONS PRIOR TO THE ISSUANCE OF A PERMANENT CERTIFICATE OF OCCUPANCY.
11. NOTWITHSTANDING ANY SURFACE IMPROVEMENTS, LANDSCAPING, PLANTING OR CHANGES SHOWN IN THESE SITE OR CONSTRUCTION PLANS, OR ACTUALLY CONSTRUCTED OR PUT IN PLACE, ALL UTILITY EASEMENTS MUST REMAIN UNOBSTRUCTED AND FULLY ACCESSIBLE ALONG THEIR ENTIRE LENGTH TO ALLOW FOR ADEQUATE MAINTENANCE EQUIPMENT. ADDITIONALLY, NO INSTALLATION, PLANTING, CHANGE IN THE SURFACE, ETC., SHALL INTERFERE WITH THE OPERATION OF THE UTILITY LINES PLACED WITHIN THE EASEMENT. BY SUBMITTING THESE SITE OR CONSTRUCTION PLANS FOR APPROVAL, THE LANDOWNER RECOGNIZES AND ACCEPTS THE TERMS, CONDITIONS AND REQUIREMENTS OF THIS NOTE.
12. FINAL GRADE SHALL BE AT LEAST SIX (6) INCHES BELOW ANY EXTERIOR WOOD SIDING ON THE PREMISES.
13. ALL INTERESTED PARTIES ARE HEREBY ALERTED THAT THIS SITE PLAN IS SUBJECT TO ADMINISTRATIVE CHANGES AND AS SHOWN ON THE ORIGINAL SITE PLAN ON FILE IN THE AURORA CITY PLANNING OFFICE AT THE MUNICIPAL BUILDING. A COPY OF THE OFFICIAL CURRENT PLAN MAY BE PURCHASED THERE. LIKEWISE, SITE PLANS ARE REQUIRED TO AGREE WITH THE APPROVED SUBDIVISION PLAT OF RECORD AT THE TIME OF A BUILDING PERMIT; AND IF NOT, MUST BE AMENDED TO AGREE WITH THE PLAT AS NEEDED, OR VICE VERSA.
14. ERRORS IN APPROVED SITE PLANS RESULTING FROM COMPUTATIONS OR INCONSISTENCIES IN THE DRAWINGS MADE BY THE APPLICANT ARE THE RESPONSIBILITY OF THE PROPERTY OWNER OF RECORD. WHERE FOUND, THE CURRENT MINIMUM CODE REQUIREMENTS WILL APPLY AT THE TIME OF BUILDING PERMIT. PLEASE BE SURE THAT ALL PLAN COMPUTATIONS ARE CORRECT.
15. ALL REPRESENTATIONS AND COMMITMENTS MADE BY APPLICANTS AND PROPERTY OWNERS AT PUBLIC HEARINGS REGARDING THIS PLAN ARE BINDING UPON THE APPLICANT, PROPERTY OWNER, AND ITS HEIRS, SUCCESSORS, AND ASSIGNS.
16. ARCHITECTURAL FEATURES, SUCH AS BAY WINDOWS, FIREPLACES, ROOF OVERHANGS, GUTTERS, EAVES, FOUNDATIONS, FOOTINGS, CANTILEVERED WALLS, ETC, ARE NOT ALLOWED TO ENCROACH INTO ANY EASEMENT OR FIRE LANE.

INDEX OF SHEETS:

- | | |
|---|------------------|
| 1 | COVER SHEET |
| 2 | DEVELOPMENT PLAN |

DATA BLOCK

LAND AREA WITHIN PROPERTY LINES	2.06 AC.
NUMBER OF BUILDINGS	1
BUILDING HEIGHT	APPROX. 30'
TOTAL BUILDING COVERAGE AND GFA	41,003 S.F. (45.70%)
HARD SURFACE AREA	48,716 S.F. (54.30%)
LANDSCAPE AREA	0 S.F.
SIDEWALKS AND PATIOS	0 S.F.
PRESENT ZONING CLASSIFICATION	M-3
MAXIMUM PERMITTED/ALLOWABLE SIGN AREA	-
PROPOSED TOTAL SIGN AREA	N/A
PROPOSED NUMBER OF SIGNS	0
PROPOSED MONUMENT SIGN	0
PROPOSED MONUMENT SIGN AREA	N/A
PARKING SPACES REQUIRED	-
PARKING SPACES PROVIDED	17
ACCESSIBLE SPACES REQUIRED	-
ACCESSIBLE SPACES PROVIDED	1
LOADING SPACES REQUIRED	-
LOADING SPACES PROVIDED	7

NOTES:

1. ALL AREAS PROVIDED IN DATA BLOCK ARE APPROXIMATE.
2. IRON MOUNTAIN OWNS THE PROPERTY TO THE SOUTH; THEREFORE, ADDITIONAL VEHICLE PARKING IS AVAILABLE ON ADJACENT PROPERTY.



3576 NORTH MOLINE STREET
REDEVELOPMENT PLAN

Cover Sheet

PROJECT NO:	17.157	PROJECT NAME: 3576 North Moline Street		
			CHECKED BY:	--
DRAWN BY:	MAC		REV. DATE:	10.12.17
DWG DATE:				

SHEET

1



ONE-SIDED ROLLING GATE AND FENCE EXAMPLE

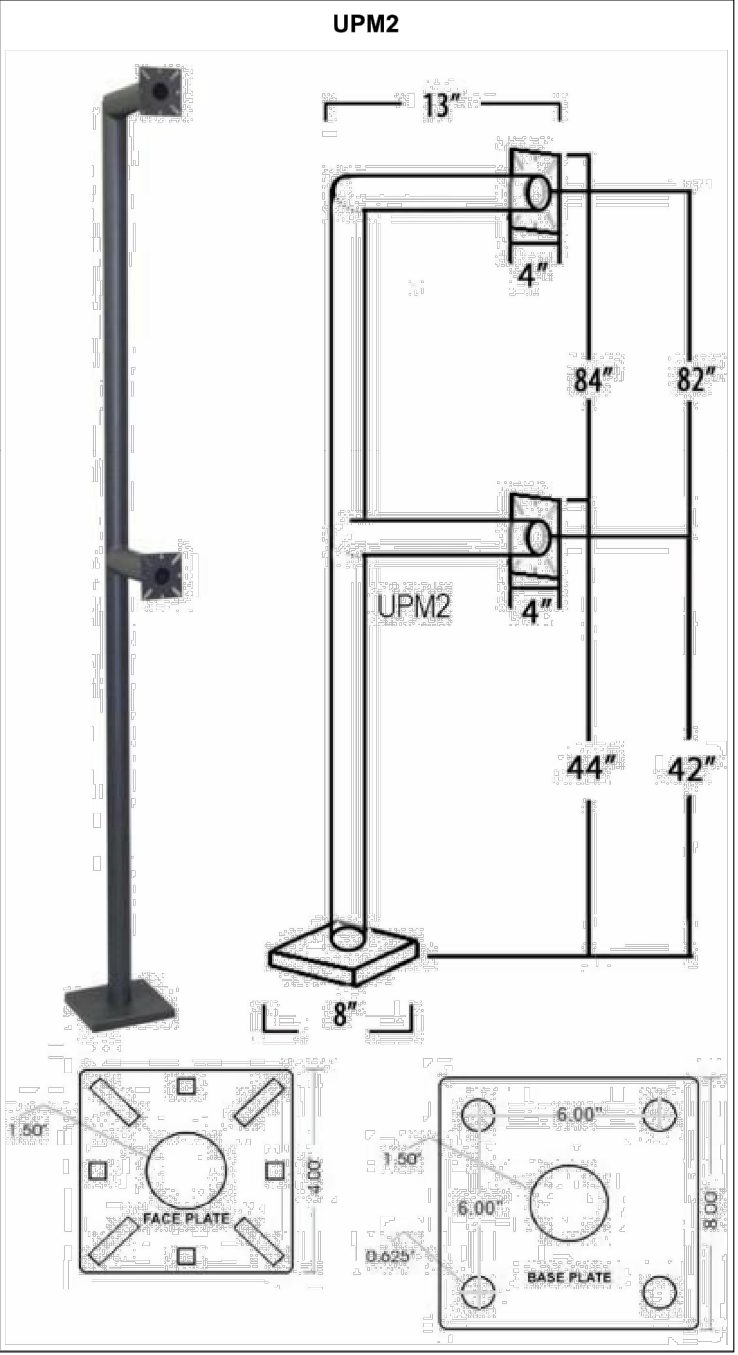

DOUBLE-GOOSENECK GATE ACCESS DETAILS

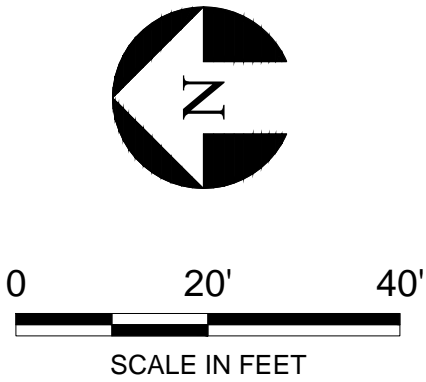
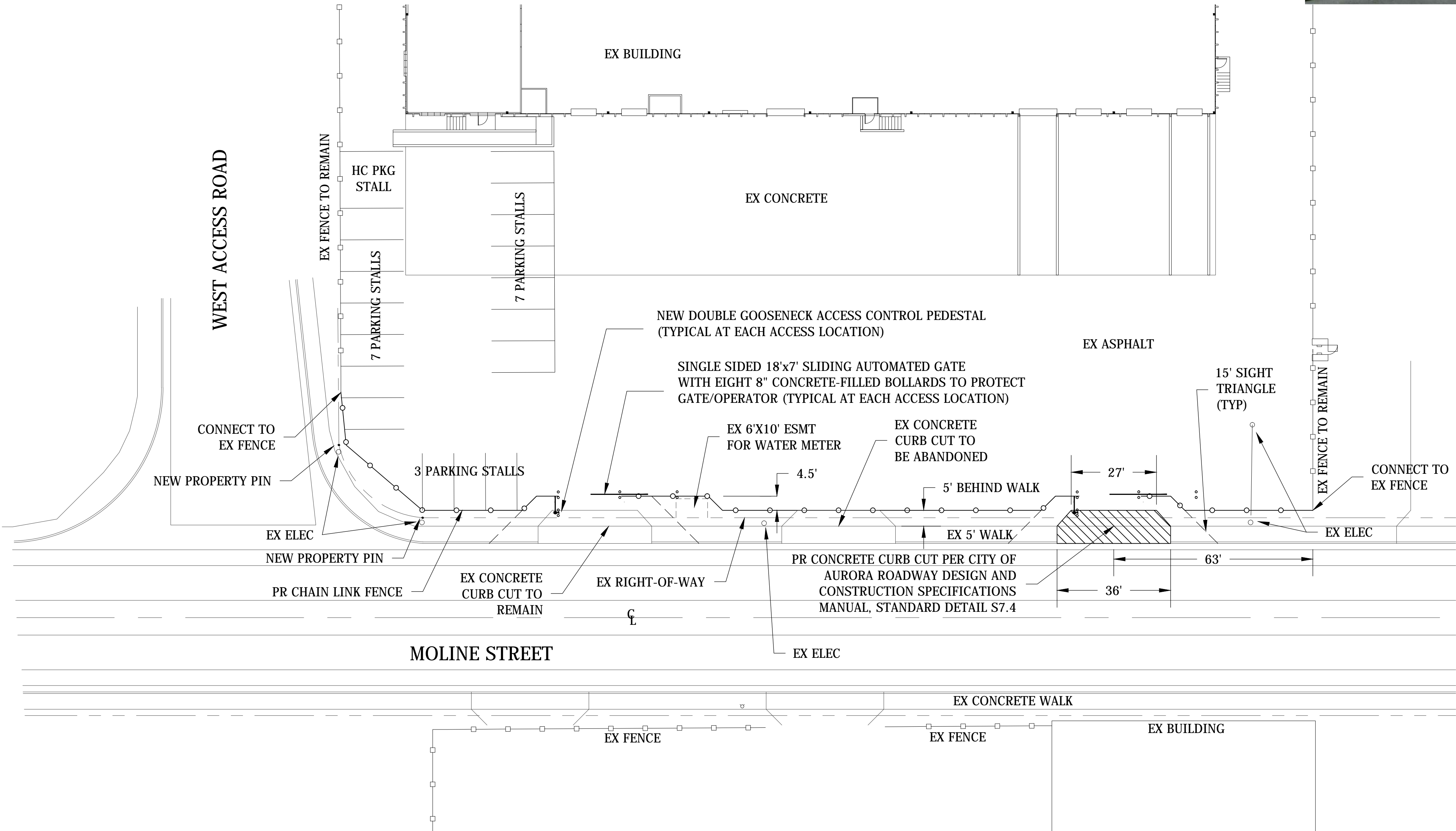



FOR BURIED UTILITY INFORMATION
THREE (3) BUSINESS DAYS
BEFORE YOU DIG
CALL 811
(or 1-800-922-1987)
UTILITY NOTIFICATION
CENTER OF COLORADO (UNCC)
www.uncc.org



3576 NORTH MOLINE STREET REDEVELOPMENT PLAN Site Plan			
PROJECT NO:	17.157		
	PROJECT NAME: 3576 North Moline Street		
	DRAWN BY:	MAC	CHECKED BY: --
	DWG DATE:	10.12.17	REV. DATE: --
SHEET 2			