

Port Colorado

Sub-Area 2

Open Space, Circulation & Neighborhood Plan

Tab #9

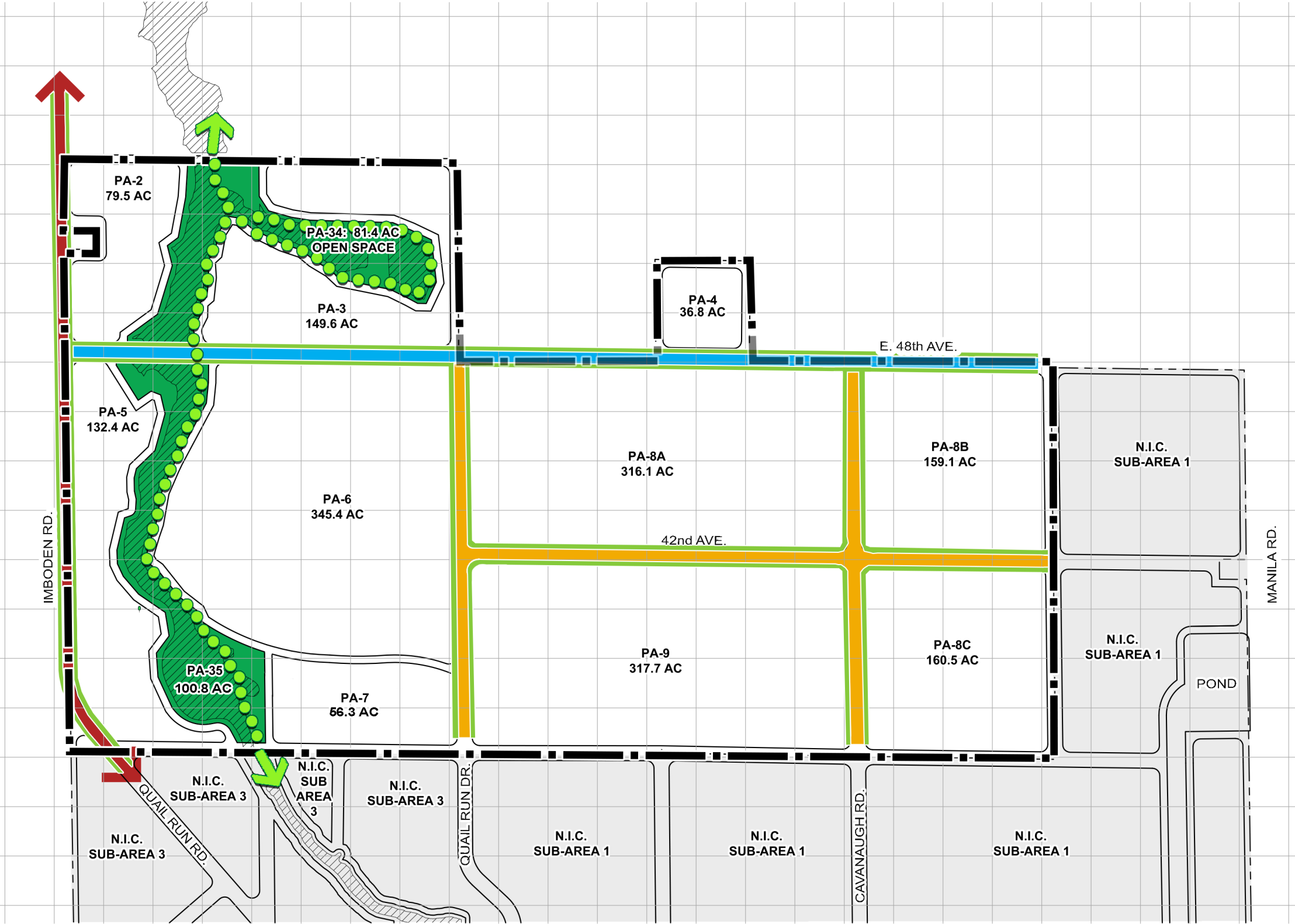

- LEGEND**
- SUB-AREA #2 BOUNDARY
 - MP BOUNDARY
 - 10 ACRE REFERENCE GRID
 - PEDESTRIAN NETWORK
 - 144' R.O.W. MAJOR ARTERIAL W/ RAISED MEDIAN/TURN LANE
 - 114' R.O.W. MINOR ARTERIAL W/ SEPARATED SHARED USE PATH
 - 84' R.O.W. COLLECTOR W/ PAINTED MEDIAN
 - PROPOSED TRAIL
 - BEAR GULCH FLOODPLAIN
 - PLANNING AREA BOUNDARY
 - OPEN SPACE (OS-D)

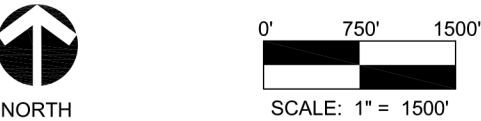

ISSUE RECORD

1st Submittal	- 09/21/2022
2nd Submittal	- 12/05/2022
3rd Submittal	- 05/10/2023



Westwood



Note: Images and Graphics are solely for reference purposes only.

