

LIGHTING FIXTURE SCHEDULE (120/277V)						
TYPE	LOAD (VA)	LAMPS	MANUFACTURER	CATALOG NUMBER	DESCRIPTION	APPROXIMATE FIXTURE COUNT
		TYPE				
A	139.7	15 LED array	US LED	QF4-x-UNVH-5-50-150	US LED - Outdoor pole mount area luminaire. Product ID: QF4-x-UNVH-5-50-150 Brown painted cast aluminum housing with fins and central driver compartment. 30 LEDs in two 15 LED arrays with clear plastic shields of individual lenses. One Philips Advance Xitanium LED driver. Model: XH180C180V144BSF1 set to 1500ma. Tested at 347 VAC and 60Hz.	68
S1	15.3	(1) Nichia NFDWJ130B-V2L c/w Philips-XI055C180V054BSJ1 @ 120.00V	LUMINIS CANADA INC.	SO600-L1L15-R30	Syrios Square 6	7
B	5	LED 4.2W	BEGA	77 266	Hardscape base led garden and pathway bollard. 3000K	6
S	14.6	24 X NICHIA LED	BEGA	PLATE 3450-2X LED HO	White textured painted structure and housing. White translucent diffuser	6
S2	30.7	(2) Nichia NFDWJ130B-V2L c/w Philips-XI055C180V054BSJ1 @ 120.00V	LUMINIS CANADA INC.	SO602-L2L15-R30	Syrios Square 6	20
L	20.2	LED'S WHITE C/W DRIVER	LUMENWERX	VIAWETASY-TMG+HLO -LED-80-500-30-4FT	VIA WET ASYM	2

STATISTICS					
DESCRIPTION	AVG	MAX	MIN	MAX/MIN	AVG/MIN
PARKING	2.0 FC	9.9 FC	0.2 FC	49.5:1	10.0:1
PERIMETER	2.8 FC	9.9 FC	0.4 FC	24.8:1	7.0:1

ELECTRICAL SITE LIGHTING PHOTOMETRICS

1/32" = 1'-0"

NELSON
Nelco Architecture, Inc.

311 Elm Street
Suite 600
Cincinnati, OH 45202
Phone: (513) 241-3000

WASHINGTON
PRIME GROUP

Contact Information

Owner
Washington Prime Group
180 E. Broad St.
Columbus, OH 43215
p: (614) 621-9000

Architect
Nelco Architecture, Inc.
311 Elm Street, Suite 600
Cincinnati, Ohio 45202
p: (513) 241-3000

Structural
Thorson Baker & Assoc.
2055 Reading Rd, Suite 450
Cincinnati, OH 45202
p: (513) 579-8200

MEP
Thorson Baker & Assoc.
3030 W. Streetsboro
Richfield, OH 44286
p: (330) 659-6688

Civil
Kimley - Horn
4502 South Uster St, Suite 1500
Denver, CO 80237
p: (303) 228-2339

Sheet Issue Information

Issued
ENTITLEMENTS 02-03-2020

Revised	Description	Date
---------	-------------	------

Professional Stamp

Project Information

Title
TC AT AURORA
FIELDHOUSE
Address
14200 E. ALAMEDA AVE.
AURORA, CO 80012

Project
Number
19.0004365

Sheet Information

Title
ELECTRICAL
SITE LIGHTING
PHOTOMETRICS

Drawn
TBA

Reviewed
TBA

Scale
As Noted

Authorized
For
ENTITLEMENTS

E1000

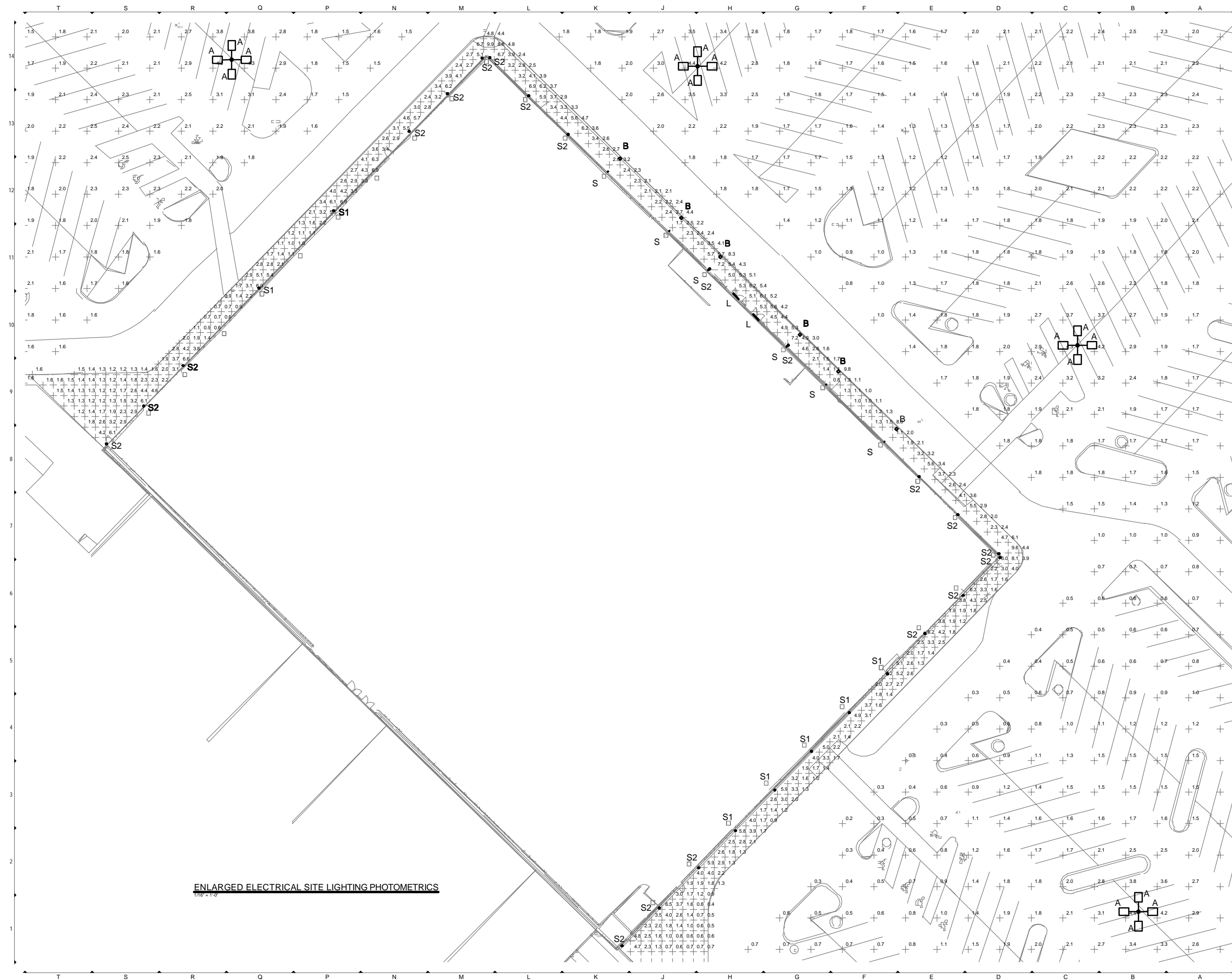

NELSON
Neiko Architecture, Inc.

311 Elm Street
Suite 600
Cincinnati, OH 45202
Phone: (513) 241-3000

**WASHINGTON
PRIME GROUP**

Contact Information

Owner p: (614) 621-9000
Washington Prime Group
180 E. Broad St.
Columbus, OH 43215

Architect p: (513) 241-3000
Nelco Architecture, Inc.
311 Elm Street, Suite 600
Cincinnati, Ohio 45202

Structural p: (513) 579-8200
Thorson Baker & Assoc.
2055 Reading Rd, Suite 450
Cincinnati, OH 45202

M/E/P p: (330) 659-6688
Thorson Baker & Assoc.
3030 W. Streetsboro
Richfield, OH 44286

Civil p: (303) 228-2339
Kimley - Horn
4582 South Ulster St, Suite 1500
Denver, CO 80237

Sheet Issue Information

Issued	ENTITLEMENTS 02-03-2020
--------	-------------------------

Revised	Δ	Description	Date
---------	----------	-------------	------

Professional Stamp

Project Information

Title TC AT AURORA
FIELDHOUSE

Address 14200 E. ALAMEDA AVE.
AURORA, CO 80012

Project Number	19.0004365
----------------	------------

Sheet Information

Title ENLARGED
ELECTRICAL
SITE LIGHTING
PHOTOMETRIC

Drawn TBA

Reviewed	TBA
----------	-----

Scale: As Noted

For ENTITLEMENTS

E1001