



T-MOBILE SITE NUMBER: DN02033C

T-MOBILE SITE NAME: AURORA EAST

SITE TYPE: MONOPOLE

TOWER HEIGHT: 59'-0"

BUSINESS UNIT #: 839586

SITE ADDRESS: 12102 EAST MISSISSIPPI

COUNTY: AURORA, CO 80012

JURISDICTION: ARAPAHOE

CITY OF AURORA, CO

T-MOBILE APU DC GENERATOR PROJECT

SITE INFORMATION	
CROWN CASTLE USA INC. SITE NAME:	AURORA EAST
SITE ADDRESS:	12102 EAST MISSISSIPPI AURORA, CO 80012
COUNTY:	ARAPAHOE
MAP/PARCEL #:	----
AREA OF CONSTRUCTION:	EXISTING
LATITUDE:	39° 41' 43.59"
LONGITUDE:	-104° 50' 42.88"
LAT/LONG TYPE:	NAD83
GROUND ELEVATION:	5583.1 FT
CURRENT ZONING:	----
JURISDICTION:	CITY OF AURORA, CO
OCCUPANCY CLASSIFICATION:	U
TYPE OF CONSTRUCTION:	IIB
A.D.A. COMPLIANCE:	FACILITY IS UNMANNED AND NOT FOR HUMAN HABITATION
PROPERTY OWNER:	----
	CITY, STATE ZIP
TOWER OWNER:	CROWN CASTLE USA, INC 2000 CORPORATE DRIVE CANONSBURG, PA 15317
CARRIER/APPLICANT:	T-MOBILE 18400 E. 22ND AVENUE AURORA, CO 80011
CROWN CASTLE USA INC. APPLICATION ID:	446384
ELECTRIC PROVIDER:	XCEL ENERGY (800) 895-4999
TELCO PROVIDER:	CENTURYLINK (281) 359-9519

PROJECT TEAM	
DESIGNER FIRM:	BROADUS SERVICES 4 COUNTRY PLACE CIRCLE DALWORTHINGTON GARDENS, TX 76016 PH: (817) 349-3449
ENGINEER FIRM:	JACOB GORALSKI, PLLC 1106 COLBI ST. KENNEDALE, TX 76060 PH: (817) 456-2621 CONTACT: JACOB GORALSKI, PLLC
CROWN CASTLE CONTACTS:	116 INVERNESS DR. EAST STE# 280 ENGLEWOOD, CO 80112 GRANT STEINHAUSER - PROJECT MANAGER GRANT.STEINHAUSER@CROWNCastle.COM (720) 450-3009 WALT RAYPOLE - CONSTRUCTION MANAGER WALT.RAYPOLE@CROWNCastle.COM (719) 466-9629 BRANDON SAENZ - A&E PROJECT MANAGER BRANDON.SAENZ.CONTRACTOR@CROWNCastle.COM (720) 450-3003
T-MOBILE CONTACTS:	MACKENZIE KEYS - MACKENZIE.KEYS2@T-MOBILE.COM

DRAWING INDEX	
SHEET #	SHEET DESCRIPTION
T-1	TITLE SHEET
T-2	GENERAL NOTES
C-1	SITE PLAN
C-2	INSTALLATION AND EQUIPMENT DETAILS
C-3	INSTALLATION AND EQUIPMENT DETAILS
C-4	BLOCK DIAGRAM & ONE-LINE DIAGRAM
C-5	SIGNAGE REQUIREMENTS
ALL DRAWINGS CONTAINED HEREIN ARE FORMATTED FOR 11X17. CONTRACTOR SHALL VERIFY ALL PLANS AND EXISTING DIMENSIONS AND CONDITIONS ON THE JOB SITE AND SHALL IMMEDIATELY NOTIFY THE ENGINEER IN WRITING OF ANY DISCREPANCIES BEFORE PROCEEDING WITH THE WORK OR BE RESPONSIBLE FOR SAME.	

APPROVALS		
APPROVAL	SIGNATURE	DATE
PROPERTY OWNER OR REP.	_____	_____
LAND USE PLANNER	_____	_____
T-MOBILE	_____	_____
OPERATIONS	_____	_____
RF	_____	_____
NETWORK	_____	_____
BACKHAUL	_____	_____
CONSTRUCTION MANAGER	_____	_____
THE PARTIES ABOVE HEREBY APPROVE AND ACCEPT THESE DOCUMENTS AND AUTHORIZE THE CONTRACTOR TO PROCEED WITH THE CONSTRUCTION DESCRIBED HEREIN. ALL CONSTRUCTION DOCUMENTS ARE SUBJECT TO REVIEW BY THE LOCAL BUILDING DEPARTMENT AND ANY CHANGES AND MODIFICATIONS THEY MAY IMPOSE.		
NOTE: PRIOR TO ACCESSING/ENTERING THE SITE YOU MUST CONTACT THE CROWN NOC AT (800) 788-7011 & CROWN CONSTRUCTION MANAGER		

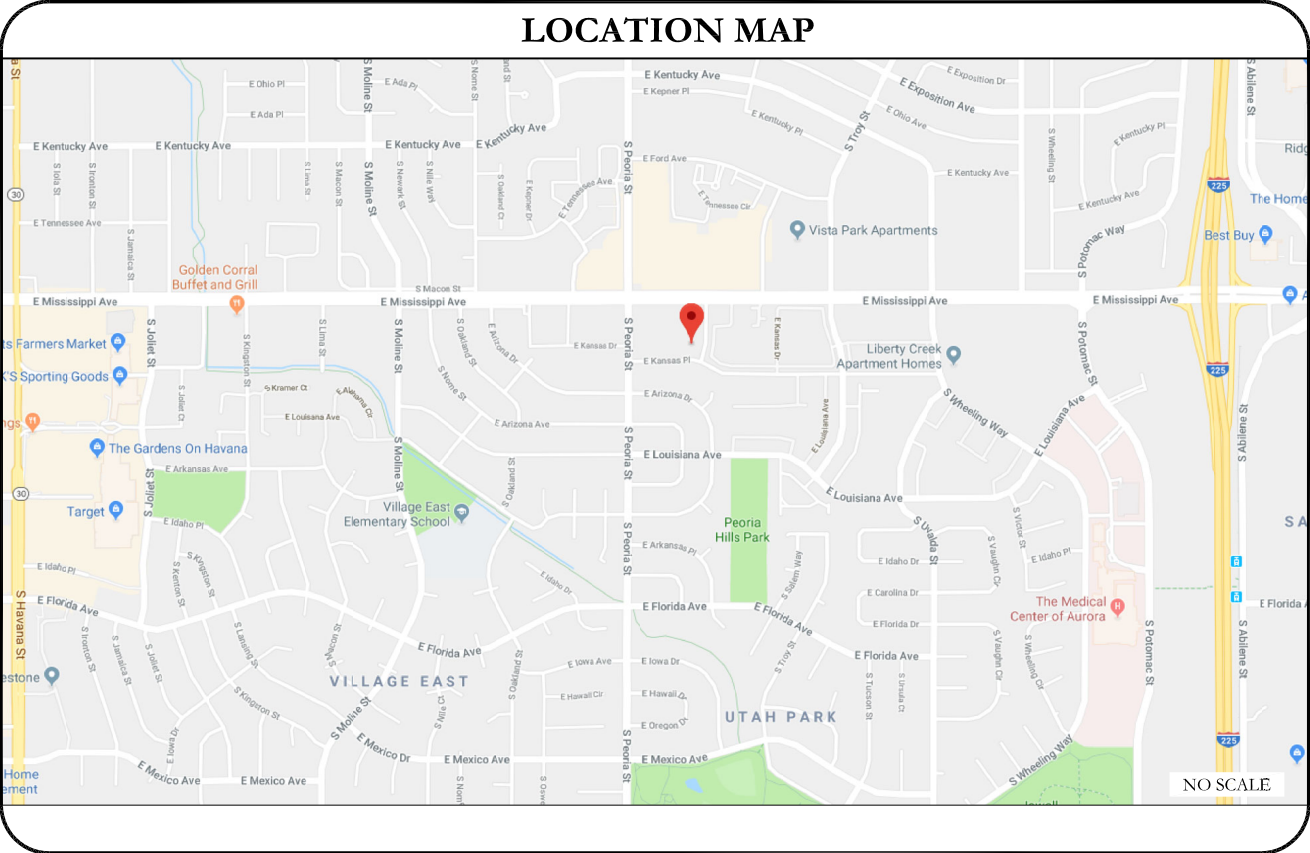

APPLICABLE CODES/REFERENCE DOCUMENTS											
THE PURPOSE OF THIS PROJECT IS TO ENHANCE BROADBAND CONNECTIVITY AND CAPACITY TO THE EXISTING ELIGIBLE WIRELESS FACILITY.	ALL WORK SHALL BE PERFORMED AND MATERIALS INSTALLED IN ACCORDANCE WITH THE CURRENT EDITIONS OF THE FOLLOWING CODES AS ADOPTED BY THE LOCAL GOVERNING AUTHORITIES. NOTHING IN THESE PLANS IS TO BE CONSTRUED TO PERMIT WORK NOT CONFORMING TO THESE CODES:										
<u>TOWER SCOPE OF WORK</u> <ul style="list-style-type: none"><li>• NO TOWER WORK</li></ul>	<table><tr><td>CODE TYPE</td><td>CODE</td></tr><tr><td>BUILDING</td><td>CURRENT EDITION</td></tr><tr><td>MECHANICAL</td><td>CURRENT EDITION</td></tr><tr><td>ELECTRICAL</td><td>CURRENT EDITION</td></tr><tr><td>LP GAS</td><td>CURRENT EDITION</td></tr></table>	CODE TYPE	CODE	BUILDING	CURRENT EDITION	MECHANICAL	CURRENT EDITION	ELECTRICAL	CURRENT EDITION	LP GAS	CURRENT EDITION
CODE TYPE	CODE										
BUILDING	CURRENT EDITION										
MECHANICAL	CURRENT EDITION										
ELECTRICAL	CURRENT EDITION										
LP GAS	CURRENT EDITION										
<u>GROUND SCOPE OF WORK</u> <ul style="list-style-type: none"><li>• NEW 25kW, 12VDC PROPANE GENERATOR (LISTED RG025)</li><li>• NEW 9' X 16' CONCRETE PAD</li></ul>											
DESIGN PACKAGE BASED ON THE APPLICATION ID: 446384 REVISION: 1	REFERENCE DOCUMENTS: NONE REQUIRED										



CALL COLORADO ONE CALL  
(800) 922-1987  
CALL 3 WORKING DAYS  
BEFORE YOU DIG!



12920 SE 38TH STREET  
BELLEVUE, WA 98006



4 COUNTRY PLACE CIRCLE  
DALWORTHINGTON GARDENS  
TEXAS 76016  
OFFICE: (817) 349 3449  
FAX: 800 401 4234

T-MOBILE SITE NUMBER:  
DN02033C

BU #: 839586  
AURORA EAST

12102 EAST MISSISSIPPI  
AURORA, CO 80012

EXISTING 59'-0" MONOPOLE

ISSUED FOR:

REV	DATE	DRWN	DESCRIPTION	DES./QA
A	11/21/2018	JAS	PRELIMINARY	ELG

THIS DOCUMENT IS  
PRELIMINARY IN  
NATURE AND IS NOT A  
FINAL, SIGNED AND  
SEALED DOCUMENT

JACOB GORALSKI, PLLC  
CONSULTING ENGINEER  
JACOB GORALSKI, PLLC  
CO PE# 0049661  
1106 COLBI ST.  
KENNEDALE, TX 76060  
(817) 456-2621

IT IS A VIOLATION OF LAW FOR ANY PERSON,  
UNLESS THEY ARE ACTING UNDER THE DIRECTION  
OF A LICENSED PROFESSIONAL ENGINEER,  
TO ALTER THIS DOCUMENT.

SHEET NUMBER:

T-1

REVISION:

A



SITE WORK GENERAL NOTES:

1. THE SUBCONTRACTOR SHALL CONTACT UTILITY LOCATING SERVICES PRIOR TO THE START OF CONSTRUCTION.
2. ALL EXISTING ACTIVE SEWER, WATER, GAS, ELECTRIC AND OTHER UTILITIES WHERE ENCOUNTERED IN THE WORK, SHALL BE PROTECTED AT ALL TIMES AND WHERE REQUIRED FOR THE PROPER EXECUTION OF THE WORK, SHALL BE RELOCATED AS DIRECTED BY CONTRACTOR. EXTREME CAUTION SHOULD BE USED BY THE SUBCONTRACTOR WHEN EXCAVATING OR DRILLING PIERS AROUND OR NEAR UTILITIES. SUBCONTRACTOR SHALL PROVIDE SAFETY TRAINING FOR THE WORKING CREW. THIS WILL INCLUDE BUT NOT BE LIMITED TO A) FALL PROTECTION B) CONFINED SPACE C) ELECTRICAL SAFETY D) TRENCHING AND EXCAVATION.
3. ALL SITE WORK TO COMPLY WITH QAS–STD–10068 "INSTALLATION STANDARDS FOR CONSTRUCTION ACTIVITIES ON CROWN CASTLE USA INC. TOWER SITE" AND LATEST VERSION OF TIA 1019 "STANDARD FOR INSTALLATION, ALTERATION, AND MAINTENANCE OF ANTENNA SUPPORTING STRUCTURES AND ANTENNAS."
4. ALL SITE WORK SHALL BE AS INDICATED ON THE STAMPED CONSTRUCTION DRAWINGS AND PROJECT SPECIFICATIONS.
5. IF NECESSARY, RUBBISH, STUMPS, DEBRIS, STICKS, STONES AND OTHER REFUSE SHALL BE REMOVED FROM THE SITE AND DISPOSED OF LEGALLY.
6. ALL EXISTING INACTIVE SEWER, WATER, GAS, ELECTRIC AND OTHER UTILITIES, WHICH INTERFERE WITH THE EXECUTION OF THE WORK, SHALL BE REMOVED AND/OR CAPPED, PLUGGED OR OTHERWISE DISCONTINUED AT POINTS WHICH WILL NOT INTERFERE WITH THE EXECUTION OF THE WORK, SUBJECT TO THE APPROVAL OF CONTRACTOR, OWNER AND/OR LOCAL UTILITIES.
7. THE SUBCONTRACTOR SHALL PROVIDE SITE SIGNAGE IN ACCORDANCE WITH THE TECHNICAL SPECIFICATION FOR SITE SIGNAGE.
8. THE SITE SHALL BE GRADED TO CAUSE SURFACE WATER TO FLOW AWAY FROM THE BTS EQUIPMENT AND TOWER AREAS.
9. NO FILL OR EMBANKMENT MATERIAL SHALL BE PLACED ON FROZEN GROUND. FROZEN MATERIALS, SNOW OR ICE SHALL NOT BE PLACED IN ANY FILL OR EMBANKMENT.
10. THE SUB GRADE SHALL BE COMPACTED AND BROUGHT TO A SMOOTH UNIFORM GRADE PRIOR TO FINISHED SURFACE APPLICATION.
11. THE AREAS OF THE OWNERS PROPERTY DISTURBED BY THE WORK AND NOT COVERED BY THE TOWER, EQUIPMENT OR DRIVEWAY, SHALL BE GRADED TO A UNIFORM SLOPE, AND STABILIZED TO PREVENT EROSION AS SPECIFIED ON THE PROJECT SPECIFICATIONS.
12. SUBCONTRACTOR SHALL MINIMIZE DISTURBANCE TO EXISTING SITE DURING CONSTRUCTION. EROSION CONTROL MEASURES, IF REQUIRED DURING CONSTRUCTION, SHALL BE IN CONFORMANCE WITH THE LOCAL GUIDELINES FOR EROSION AND SEDIMENT CONTROL.
13. NOTICE TO PROCEED– NO WORK TO COMMENCE PRIOR TO COMPANY'S WRITTEN NOTICE TO PROCEED AND THE ISSUANCE OF A PURCHASE ORDER.
14. ALL CONSTRUCTION MEANS AND METHODS; INCLUDING BUT NOT LIMITED TO, ERECTION PLANS, RIGGING PLANS, CLIMBING PLANS, AND RESCUE PLANS SHALL BE THE RESPONSIBILITY OF THE GENERAL CONTRACTOR RESPONSIBLE FOR THE EXECUTION OF THE WORK CONTAINED HEREIN AND SHALL MEET ANSI/ASSE A10.48 (LATEST EDITION); FEDERAL, STATE, AND LOCAL REGULATIONS; AND ANY APPLICABLE INDUSTRY CONSENSUS STANDARDS RELATED TO THE CONSTRUCTION ACTIVITIES BEING PERFORMED. ALL RIGGING PLANS SHALL ADHERE TO ANSI/ASSE A10.48 (LATEST EDITION) AND CROWN STANDARD CED–STD–10253 INCLUDING THE REQUIRED INVOLVEMENT OF A QUALIFIED ENGINEER FOR CLASS IV CONSTRUCTION TO CERTIFY THE SUPPORTING STRUCTURE(S) IN ACCORDANCE WITH THE ANSI/TIA–322 (LATEST EDITION).

STRUCTURAL STEEL NOTES:

1. ALL STEEL WORK SHALL BE PAINTED IN ACCORDANCE WITH THE PROJECT SPECIFICATIONS AND IN ACCORDANCE WITH ASTM A36 UNLESS OTHERWISE NOTED.
2. BOLTED CONNECTIONS SHALL BE ASTM A325 BEARING TYPE (3/4") CONNECTIONS AND SHALL HAVE MINIMUM OF TWO BOLTS UNLESS NOTED OTHERWISE.
3. NON–STRUCTURAL CONNECTIONS FOR STEEL GRATING MAY USE 5/8" ASTM A307 BOLTS UNLESS NOTED OTHERWISE.
4. INSTALLATION OF CONCRETE EXPANSION/WEDGE ANCHOR, SHALL BE PER MANUFACTURER'S RECOMMENDED PROCEDURE. THE ANCHOR BOLT, DOWEL OR ROD SHALL CONFORM TO MANUFACTURER'S RECOMMENDATION FOR EMBEDMENT DEPTH OR AS SHOWN ON THE DRAWINGS. NO REBAR SHALL BE CUT WITHOUT PRIOR CONTRACTOR APPROVAL WHEN DRILLING HOLES IN CONCRETE. SPECIAL INSPECTIONS, REQUIRED BY GOVERNING CODES, SHALL BE PERFORMED IN ORDER TO MAINTAIN MANUFACTURER'S MAXIMUM ALLOWABLE LOADS.

CONCRETE AND REINFORCING STEEL NOTES:

1. ALL CONCRETE WORK SHALL BE IN ACCORDANCE WITH THE ACI 301, ACI 318, ACI 336, ASTM A184, ASTM A185 AND THE DESIGN AND CONSTRUCTION SPECIFICATION FOR CAST–IN–PLACE CONCRETE.
2. ALL CONCRETE SHALL HAVE A MINIMUM COMPRESSIVE STRENGTH OF 3000 PSI AT 28 DAYS, UNLESS NOTED OTHERWISE. SLAB FOUNDATION DESIGN ASSUMING ALLOWABLE SOIL BEARING PRESSURE OF 2000 PSF.
3. REINFORCING STEEL SHALL CONFORM TO ASTM A615, GRADE 60, DEFORMED UNLESS NOTED OTHERWISE. WELDED WIRE FABRIC SHALL CONFORM TO ASTM A185 WELDED STEEL WIRE FABRIC UNLESS NOTED OTHERWISE. SPLICES SHALL BE CLASS "B" AND ALL HOOKS SHALL BE STANDARD, UNO.
4. THE FOLLOWING MINIMUM CONCRETE COVER SHALL BE PROVIDED FOR REINFORCING STEEL UNLESS SHOWN OTHERWISE ON DRAWINGS:

CONCRETE CAST AGAINST EARTH.....3 IN.  
CONCRETE EXPOSED TO EARTH OR WEATHER:  
#6 AND LARGER.....2 IN.  
#5 AND SMALLER & WWF.....1 1/2 IN.  
CONCRETE NOT EXPOSED TO EARTH OR WEATHER OR NOT CAST AGAINST THE GROUND:  
SLAB AND WALLS.....3/4 IN.  
BEAMS AND COLUMNS.....1 1/2 IN.
5. A CHAMFER 3/4" SHALL BE PROVIDED AT ALL EXPOSED EDGES OF CONCRETE, UNLESS NOTED OTHERWISE. IN ACCORDANCE WITH ACI 301 SECTION 4.2.4.

MASONRY NOTES:

1. HOLLOW CONCRETE MASONRY UNITS SHALL MEET A.S.T.M. SPECIFICATION C90, GRADE N. TYPE 1. THE SPECIFIED DESIGN COMPRESSIVE STRENGTH OF CONCRETE MASONRY (F'm) SHALL BE 1500 PSI.
2. MORTAR SHALL MEET THE PROPERTY SPECIFICATION OF A.S.T.M. C270 TYP. "S" MORTAR AND SHALL HAVE A MINIMUM COMPRESSIVE STRENGTH OF 2000 PSI.
3. GROUT SHALL MEET A.S.T.M. SPECIFICATION C475 AND HAVE A MINIMUM 28 DAY COMPRESSIVE STRENGTH OF 2000 PSI.
4. CONCRETE MASONRY SHALL BE LAID IN RUNNING (COMMON) BOND.
5. WALL SHALL RECEIVE TEMPORARY BRACING. TEMPORARY BRACING SHALL NOT BE REMOVED UNTIL GROUT IS FULLY CURED.

GENERAL NOTES:

1. FOR THE PURPOSE OF CONSTRUCTION DRAWING, THE FOLLOWING DEFINITIONS SHALL APPLY:

CONTRACTOR–  
SUBCONTRACTOR–  
CARRIER–  
TOWER OWNER–  
OEM–













GENERAL CONTRACTOR (CONSTRUCTION)  
T–MOBILE  
CROWN CASTLE USA INC.  
ORIGINAL EQUIPMENT MANUFACTURER
2. PRIOR TO THE SUBMISSION OF BIDS, THE BIDDING SUBCONTRACTOR SHALL VISIT THE CELL SITE TO FAMILIARIZE WITH THE EXISTING CONDITIONS AND TO CONFIRM THAT THE WORK CAN BE ACCOMPLISHED AS SHOWN ON THE CONSTRUCTION DRAWINGS. ANY DISCREPANCY FOUND SHALL BE BROUGHT TO THE ATTENTION OF CONTRACTOR AND CROWN CASTLE USA INC.
3. ALL MATERIALS FURNISHED AND INSTALLED SHALL BE IN STRICT ACCORDANCE WITH ALL APPLICABLE CODES, REGULATIONS AND ORDINANCES. SUBCONTRACTOR SHALL ISSUE ALL APPROPRIATE NOTICES AND COMPLY WITH ALL LAWS, ORDINANCES, RULES, REGULATIONS AND LAWFUL ORDERS OF ANY PUBLIC AUTHORITY REGARDING THE PERFORMANCE OF THE WORK. ALL WORK CARRIED OUT SHALL COMPLY WITH ALL APPLICABLE MUNICIPAL AND UTILITY COMPANY SPECIFICATIONS AND LOCAL JURISDICTIONAL CODES, ORDINANCES AND APPLICABLE REGULATIONS.
4. DRAWINGS PROVIDED HERE ARE NOT TO SCALE AND ARE INTENDED TO SHOW OUTLINE ONLY.
5. UNLESS NOTED OTHERWISE, THE WORK SHALL INCLUDE FURNISHING MATERIALS, EQUIPMENT, APPURTENANCES AND LABOR NECESSARY TO COMPLETE ALL INSTALLATIONS AS INDICATED ON THE DRAWINGS.
6. "KITTING LIST" SUPPLIED WITH THE BID PACKAGE IDENTIFIES ITEMS THAT WILL BE SUPPLIED BY CONTRACTOR. ITEMS NOT INCLUDED IN THE BILL OF MATERIALS AND KITTING LIST SHALL BE SUPPLIED BY THE SUBCONTRACTOR.
7. THE SUBCONTRACTOR SHALL INSTALL ALL EQUIPMENT AND MATERIALS IN ACCORDANCE WITH MANUFACTURER'S RECOMMENDATIONS UNLESS SPECIFICALLY STATED OTHERWISE.
8. IF THE SPECIFIED EQUIPMENT CAN NOT BE INSTALLED AS SHOWN ON THESE DRAWINGS, THE SUBCONTRACTOR SHALL PROPOSE AN ALTERNATIVE INSTALLATION FOR APPROVAL BY THE CONTRACTOR AND CROWN CASTLE USA INC. PRIOR TO PROCEEDING WITH ANY SUCH CHANGE OF INSTALLATION.
9. SUBCONTRACTOR SHALL DETERMINE ACTUAL ROUTING OF CONDUIT, POWER AND T1 CABLES, GROUNDING CABLES AS SHOWN ON THE POWER, GROUNDING AND TELCO PLAN DRAWINGS.
10. THE SUBCONTRACTOR SHALL PROTECT EXISTING IMPROVEMENTS, PAVEMENTS, CURBS, LANDSCAPING AND STRUCTURES. ANY DAMAGED PART SHALL BE REPAIRED AT SUBCONTRACTOR'S EXPENSE TO THE SATISFACTION OF OWNER.
11. SUBCONTRACTOR SHALL LEGALLY AND PROPERLY DISPOSE OF ALL SCRAP MATERIALS SUCH AS COAXIAL CABLES AND OTHER ITEMS REMOVED FROM THE EXISTING FACILITY. ANTENNAS REMOVED SHALL BE RETURNED TO THE OWNER'S DESIGNATED LOCATION.
12. SUBCONTRACTOR SHALL LEAVE PREMISES IN CLEAN CONDITION. TRASH AND DEBRIS SHOULD BE REMOVED FROM SITE ON A DAILY BASIS.

ABBREVIATIONS AND SYMBOLS:

ABBREVIATIONS:

AGL ABOVE GRADE LEVEL  
BTS BASE TRANSCIEVER STATION  
(E) EXISTING  
MIN. MINIMUM  
REF REFERENCE  
RF RADIO FREQUENCY  
T.B.D. TO BE DETERMINED  
T.B.R. TO BE RESOLVED  
TYP TYPICAL  
REQ REQUIRED  
EGR EQUIPMENT GROUND RING  
AWG AMERICAN WIRE GAUGE  
MGB MASTER GROUND BAR  
EG EQUIPMENT GROUND  
BCW BARE COPPER WIRE  
SIAD SMART INTEGRATED ACCESS DEVICE  
GEN GENERATOR  
IGR INTERIOR GROUND RING (HALO)  
RBS RADIO BASE STATION

SYMBOLS:

 SOLID GROUND BUS BAR  
 SOLID NEUTRAL BUS BAR  
 SUPPLEMENTAL GROUND CONDUCTOR  
 2–POLE THERMAL–MAGNETIC CIRCUIT BREAKER  
 SINGLE–POLE THERMAL–MAGNETIC CIRCUIT BREAKER  
 CHEMICAL GROUND ROD  
 TEST WELL  
 DISCONNECT SWITCH  
 METER  
 EXOTHERMIC WELD (CADWELD) (UNLESS OTHERWISE NOTED)  
 MECHANICAL CONNECTION  
 GROUNDING WIRE

ELECTRICAL INSTALLATION NOTES:

1. ALL ELECTRICAL WORK SHALL BE PERFORMED IN ACCORDANCE WITH THE PROJECT SPECIFICATIONS, NEC AND ALL APPLICABLE FEDERAL, STATE, AND LOCAL CODES/ORDINANCES.
2. CONDUIT ROUTINGS ARE SCHEMATIC. SUBCONTRACTOR SHALL INSTALL CONDUITS SO THAT ACCESS TO EQUIPMENT IS NOT BLOCKED AND TRIP HAZARDS ARE ELIMINATED.
3. WIRING, RACEWAY AND SUPPORT METHODS AND MATERIALS SHALL COMPLY WITH THE REQUIREMENTS OF THE NEC. HILTI EPOXY ANCHORS ARE REQUIRED BY CROWN CASTLE USA INC.
4. ALL CIRCUITS SHALL BE SEGREGATED AND MAINTAIN MINIMUM CABLE SEPARATION AS REQUIRED BY THE NEC.
5. CABLES SHALL NOT BE ROUTED THROUGH LADDER–STYLE CABLE TRAY RUNGS.
6. EACH END OF EVERY POWER, POWER PHASE CONDUCTOR (I.E., HOTS), GROUNDING AND T1 CONDUCTOR AND CABLE SHALL BE LABELED WITH COLOR–CODED INSULATION OR ELECTRICAL TAPE (3M BRAND, 1/2" PLASTIC ELECTRICAL TAPE WITH UV PROTECTION, OR EQUAL). THE IDENTIFICATION METHOD SHALL CONFORM WITH NEC AND OSHA.
7. ALL ELECTRICAL COMPONENTS SHALL BE CLEARLY LABELED WITH PLASTIC TAPE PER COLOR SCHEDULE. ALL EQUIPMENT SHALL BE LABELED WITH THEIR VOLTAGE RATING, PHASE CONFIGURATION, WIRE CONFIGURATION, POWER OR AMPACITY RATING AND BRANCH CIRCUIT ID NUMBERS (I.E. PANEL BOARD AND CIRCUIT ID'S).
8. PANEL BOARDS (ID NUMBERS) AND INTERNAL CIRCUIT BREAKERS (CIRCUIT ID NUMBERS) SHALL BE CLEARLY LABELED WITH PLASTIC LABELS.
9. ALL TIE WRAPS SHALL BE CUT FLUSH WITH APPROVED CUTTING TOOL TO REMOVE SHARP EDGES.
10. POWER, CONTROL AND EQUIPMENT GROUND WIRING IN TUBING OR CONDUIT SHALL BE SINGLE CONDUCTOR (#14 AWG OR LARGER), 600 V, OIL RESISTANT THHN OR THWN–2, CLASS B STRANDED COPPER CABLE RATED FOR 90° C (WET & DRY) OPERATION LISTED OR LABELED FOR THE LOCATION AND RACEWAY SYSTEM USED UNLESS OTHERWISE SPECIFIED.
11. SUPPLEMENTAL EQUIPMENT GROUND WIRING LOCATED INDOORS SHALL BE SINGLE CONDUCTOR (#6 AWG OR LARGER), 600V, OIL RESISTANT THHN OR THWN–2 GREEN INSULATION CLASS B STRANDED COPPER CABLE RATED FOR 90° C (WET AND DRY) OPERATION LISTED OR LABELED FOR THE LOCATION AND RACEWAY SYSTEM USED UNLESS OTHERWISE SPECIFIED.
12. POWER AND CONTROL WIRING, NOT IN TUBING OR CONDUIT, SHALL BE MULTI–CONDUCTOR, TYPE TC CABLE (#14 AWG OR LARGER), 600 V, OIL RESISTANT THHN OR THWN–2, CLASS B STRANDED COPPER CABLE RATED FOR 90° C (WET AND DRY) OPERATION WITH OUTER JACKET LISTED OR LABELED FOR THE LOCATION USED UNLESS OTHERWISE SPECIFIED.
13. ALL POWER AND GROUNDING CONNECTIONS SHALL BE CRIMP–STYLE, COMPRESSION WIRE LUGS AND WIRE NUTS BY THOMAS AND BETTS (OR EQUAL). LUGS AND WIRE NUTS SHALL BE RATED FOR OPERATION AT NO LESS THAN 75° C (90° C IF AVAILABLE).
14. RACEWAY AND CABLE TRAY SHALL BE LISTED OR LABELED FOR ELECTRICAL USE IN ACCORDANCE WITH NEMA, UL, ANSI/IEEE AND NEC.
15. ELECTRICAL METALLIC TUBING (EMT) OR RIGID NONMETALLIC CONDUIT (I.E. RIGID PVC SCHEDULE 40 OR RIGID PVC SCHEDULE 80 FOR LOCATIONS SUBJECT TO PHYSICAL DAMAGE) SHALL BE USED FOR EXPOSED INDOOR LOCATIONS.
16. ELECTRICAL METALLIC TUBING (EMT), ELECTRICAL NONMETALLIC TUBING (ENT) OR RIGID NONMETALLIC CONDUIT (RIGID PVC, SCHEDULE 40) SHALL BE USED FOR CONCEALED INDOOR LOCATIONS.
17. SCHEDULE 40 PVC UNDERGROUND ON STRAIGHTS AND SCHEDULE 80 PVC FOR ALL ELBOWS/90s AND ALL APPROVED ABOVE GRADE PVC CONDUIT.
18. LIQUID–TIGHT FLEXIBLE METALLIC CONDUIT (LIQUID–TITE FLEX) SHALL BE USED INDOORS AND OUTDOORS, WHERE VIBRATION OCCURS OR FLEXIBILITY IS NEEDED.
19. CONDUIT AND TUBING FITTINGS SHALL BE THREADED OR COMPRESSION–TYPE AND APPROVED FOR THE LOCATION USED. SET SCREW FITTINGS ARE NOT ACCEPTABLE.
20. CABINETS, BOXES AND WIRE WAYS SHALL BE LABELED FOR ELECTRICAL USE IN ACCORDANCE WITH NEMA, UL, ANSI/IEEE AND NEC.
21. WIREWAYS SHALL BE EPOXY–COATED (GRAY) AND INCLUDE A HINGED COVER, DESIGNED TO SWING OPEN DOWNWARDS; SHALL BE PANDUIT TYPE E (OR EQUAL); AND RATED NEMA 1 (OR BETTER).
22. CONDUITS SHALL BE FASTENED SECURELY IN PLACE WITH APPROVED NON–PERFORATED STRAPS AND HANGERS. EXPLOSIVE DEVICES FOR ATTACHING HANGERS TO STRUCTURE WILL NOT BE PERMITTED. CLOSELY FOLLOW THE LINES OF THE STRUCTURE, MAINTAIN CLOSE PROXIMITY TO THE STRUCTURE AND KEEP CONDUITS IN TIGHT ENVELOPES. CHANGES IN DIRECTION TO ROUTE AROUND OBSTACLES SHALL BE MADE WITH CONDUIT OUTLET BODIES. CONDUIT SHALL BE INSTALLED IN A NEAT AND WORKMANLIKE MANNER. PARALLEL AND PERPENDICULAR TO STRUCTURE WALL AND CEILING LINES. ALL CONDUIT SHALL BE FISHED TO CLEAR OBSTRUCTIONS. ENDS OF CONDUITS SHALL BE TEMPORARILY CAPPED FLUSH TO FINISH GRADE TO PREVENT CONCRETE, PLASTER OR DIRT FROM ENTERING. CONDUITS SHALL BE RIGIDLY CLAMPED TO BOXES BY GALVANIZED MALLEABLE IRON BUSHIN ON INSIDE AND GALVANIZED MALLEABLE IRON LOCKNUT ON OUTSIDE AND INSIDE.
23. EQUIPMENT CABINETS, TERMINAL BOXES, JUNCTION BOXES AND PULL BOXES SHALL BE GALVANIZED OR EPOXY–COATED SHEET STEEL; SHALL MEET OR EXCEED UL 50 AND RATED NEMA 1 (OR BETTER) INDOORS OR NEMA 3R (OR BETTER) OUTDOORS.
24. METAL RECEPTACLE, SWITCH AND DEVICE BOXES SHALL BE GALVANIZED, EPOXY–COATED OR NON–CORRODING; SHALL MEET OR EXCEED UL 514A AND NEMA OS 1; AND RATED NEMA 1 (OR BETTER) INDOORS OR WEATHER PROTECTED (WP OR BETTER) OUTDOORS.
25. NONMETALLIC RECEPTACLE, SWITCH AND DEVICE BOXES SHALL MEET OR EXCEED NEMA OS 2; AND RATED NEMA 1 (OR BETTER) INDOORS OR WEATHER PROTECTED (WP OR BETTER) OUTDOORS.
26. THE SUBCONTRACTOR SHALL NOTIFY AND OBTAIN NECESSARY AUTHORIZATION FROM THE CONTRACTOR BEFORE COMMENCING WORK ON THE AC POWER DISTRIBUTION PANELS.
27. THE SUBCONTRACTOR SHALL PROVIDE NECESSARY TAGGING ON THE BREAKERS, CABLES AND DISTRIBUTION PANELS IN ACCORDANCE WITH THE APPLICABLE CODES AND STANDARDS TO SAFEGUARD LIFE AND PROPERTY.
28. INSTALL PLASTIC LABEL ON THE METER CENTER TO SHOW "T–MOBILE".
29. ALL CONDUITS THAT ARE INSTALLED ARE TO HAVE A METERED MULE TAPE PULL CORD INSTALLED.

GREENFIELD GROUNDING NOTES:

1. ALL GROUND ELECTRODE SYSTEMS (INCLUDING TELECOMMUNICATION, RADIO, LIGHTNING PROTECTION AND AC POWER GES'S) SHALL BE BONDED TOGETHER AT OR BELOW GRADE, BY TWO OR MORE COPPER BONDING CONDUCTORS IN ACCORDANCE WITH THE NEC.
2. THE SUBCONTRACTOR SHALL PERFORM IEEE FALL–OF–POTENTIAL RESISTANCE TO EARTH TESTING (PER IEEE 1100 AND 81) FOR GROUND ELECTRODE SYSTEMS. THE SUBCONTRACTOR SHALL FURNISH AND INSTALL SUPPLEMENTAL GROUND ELECTRODES AS NEEDED TO ACHIEVE A TEST RESULT OF 5 OHMS OR LESS.
3. THE SUBCONTRACTOR IS RESPONSIBLE FOR PROPERLY SEQUENCING GROUNDING AND UNDERGROUND CONDUIT INSTALLATION AS TO PREVENT ANY LOSS OF CONTINUITY IN THE GROUNDING SYSTEM OR DAMAGE TO THE CONDUIT AND PROVIDE TESTING RESULTS.
4. METAL CONDUIT AND TRAY SHALL BE GROUNDED AND MADE ELECTRICALLY CONTINUOUS WITH LISTED BONDING FITTINGS OR BY BONDING ACROSS THE DISCONTINUITY WITH #6 AWG COPPER WIRE UL APPROVED GROUNDING TYPE CONDUIT CLAMPS.
5. METAL RACEWAY SHALL NOT BE USED AS THE NEC REQUIRED EQUIPMENT GROUND CONDUCTOR. STRANDED COPPER CONDUCTORS WITH GREEN INSULATION, SIZED IN ACCORDANCE WITH THE NEC, SHALL BE FURNISHED AND INSTALLED WITH THE POWER CIRCUITS TO BTS EQUIPMENT.
6. EACH CABINET FRAME SHALL BE DIRECTLY CONNECTED TO THE MASTER GROUND BAR WITH GREEN INSULATED SUPPLEMENTAL EQUIPMENT GROUND WIRES, 6 AWG STRANDED COPPER OR LARGER FOR INDOOR BTS; #2 AWG SOLID TINNED COPPER FOR OUTDOOR BTS.
7. CONNECTIONS TO THE GROUND BUS SHALL NOT BE DOUBLED UP OR STACKED BACK TO BACK CONNECTIONS ON OPPOSITE SIDE OF THE GROUND BUS ARE PERMITTED.
8. ALL EXTERIOR GROUND CONDUCTORS BETWEEN EQUIPMENT/GROUND BARS AND THE GROUND RING SHALL BE #2 AWG SOLID TINNED COPPER UNLESS OTHERWISE INDICATED.
9. ALUMINUM CONDUCTOR OR COPPER CLAD STEEL CONDUCTOR SHALL NOT BE USED FOR GROUNDING CONNECTIONS.
10. USE OF 90° BENDS IN THE PROTECTION GROUNDING CONDUCTORS SHALL BE AVOIDED WHEN 45° BENDS CAN BE ADEQUATELY SUPPORTED.
11. EXOTHERMIC WELDS SHALL BE USED FOR ALL GROUNDING CONNECTIONS BELOW GRADE.
12. ALL GROUND CONNECTIONS ABOVE GRADE (INTERIOR AND EXTERIOR) SHALL BE FORMED USING HIGH PRESS CRIMPS.
13. COMPRESSION GROUND CONNECTIONS MAY BE REPLACED BY EXOTHERMIC WELD CONNECTIONS.
14. ICE BRIDGE BONDING CONDUCTORS SHALL BE EXOTHERMICALLY BONDED OR BOLTED TO THE BRIDGE AND THE TOWER GROUND BAR.
15. APPROVED ANTIOXIDANT COATINGS (I.E. CONDUCTIVE GEL OR PASTE) SHALL BE USED ON ALL COMPRESSION AND BOLTED GROUND CONNECTIONS.
16. ALL EXTERIOR GROUND CONNECTIONS SHALL BE COATED WITH A CORROSION RESISTANT MATERIAL.
17. MISCELLANEOUS ELECTRICAL AND NON–ELECTRICAL METAL BOXES, FRAMES AND SUPPORTS SHALL BE BONDED TO THE GROUND RING, IN ACCORDANCE WITH THE NEC.
18. BOND ALL METALLIC OBJECTS WITHIN 6 FT. OF MAIN GROUND WIRES WITH 1–#2 AWG TIN–PLATED COPPER GROUND CONDUCTOR.
19. GROUND CONDUCTORS USED IN THE FACILITY GROUND AND LIGHTNING PROTECTION SYSTEMS SHALL NOT BE ROUTED THROUGH METALLIC OBJECTS THAT FORM A RING AROUND THE CONDUCTOR, SUCH AS METALLIC CONDUITS, METAL SUPPORT CLIPS OR SLEEVES THROUGH WALLS OR FLOORS, WHEN IT IS REQUIRED TO BE HOUSED IN CONDUIT TO MEET CODE REQUIREMENTS OR LOCAL CONDITIONS, NON–METALLIC MATERIAL SUCH AS PVC PLASTIC CONDUIT SHALL BE USED, WHERE USE OF METAL CONDUIT IS UNAVOIDABLE (E.G., NONMETALLIC CONDUIT PROHIBITED BY LOCAL CODE) THE GROUND CONDUCTOR SHALL BE BONDED TO EACH END OF THE METAL CONDUIT.
20. ALL GROUNDS THAT TRANSITION FROM BELOW GRADE TO ABOVE GRADE MUST BE #2 TINNED SOLID IN 3/4" LIQUID TIGHT CONDUIT FROM 24" BELOW GRADE TO WITHIN 3" TO 6" OF CAD–WELD TERMINATION POINT. THE EXPOSED END OF THE LIQUID TIGHT CONDUIT MUST BE SEALED WITH SILICONE CAULK. (ADD TRANSITIONING GROUND STANDARD DETAIL AS WELL).

NEC INSULATOR COLOR CODE		
DESCRIPTION	PHASE/CODE LETTER	WIRE COLOR
240/120 1Ø	LEG 1	BLACK
	LEG 2	RED
AC NEUTRAL	N	WHITE
GROUND (EGC)	G	GREEN
VDC POS	+	*RED–POLARITY MARK AT TERMINATION
VDC NEG	–	*BLACK–POLARITY MARK AT TERMINATION
240V OR 208V, 3Ø	PHASE A	BLACK
	PHASE B	RED(ORG. IF HI LEG)
	PHASE C	BLUE
480V, 3Ø	PHASE A	BROWN
	PHASE B	ORANGE OR PURPLE
	PHASE C	YELLOW

\* SEE NEC 210.5(C)(1) AND (2)



12920 SE 38TH STREET  
BELLEVUE, WA 98006

BROADUS

services

4 COUNTRY PLACE CIRCLE  
DALWORTHINGTON GARDENS  
TEXAS 76016  
OFFICE: (817) 349 3449  
FAX: 800 401 4234

T-MOBILE SITE NUMBER:  
DN02033C

BU #: 839586  
AURORA EAST

12102 EAST MISSISSIPPI  
AURORA, CO 80012

EXISTING 59'-0" MONOPOLE

ISSUED FOR:

REV	DATE	DRWN	DESCRIPTION	DES./QA
A	11/21/2018	JAS	PRELIMINARY	ELG

THIS DOCUMENT IS  
PRELIMINARY IN  
NATURE AND IS NOT A  
FINAL, SIGNED AND  
SEALED DOCUMENT

JACOB GORALSKI, PLLC  
CONSULTING ENGINEER  
JACOB GORALSKI, PLLC  
CO PE# 0049661  
1106 COLBI ST.  
KENNEDELE, TX 76060  
(817) 456–2621

IT IS A VIOLATION OF LAW FOR ANY PERSON,  
UNLESS THEY ARE ACTING UNDER THE DIRECTION  
OF A LICENSED PROFESSIONAL ENGINEER,  
TO ALTER THIS DOCUMENT.

SHEET NUMBER:

T-2

REVISION:

A

NEW T-MOBILE WOODEN  
COMPOUND FENCE SECTION  
(TO MATCH EXISTING FENCE)

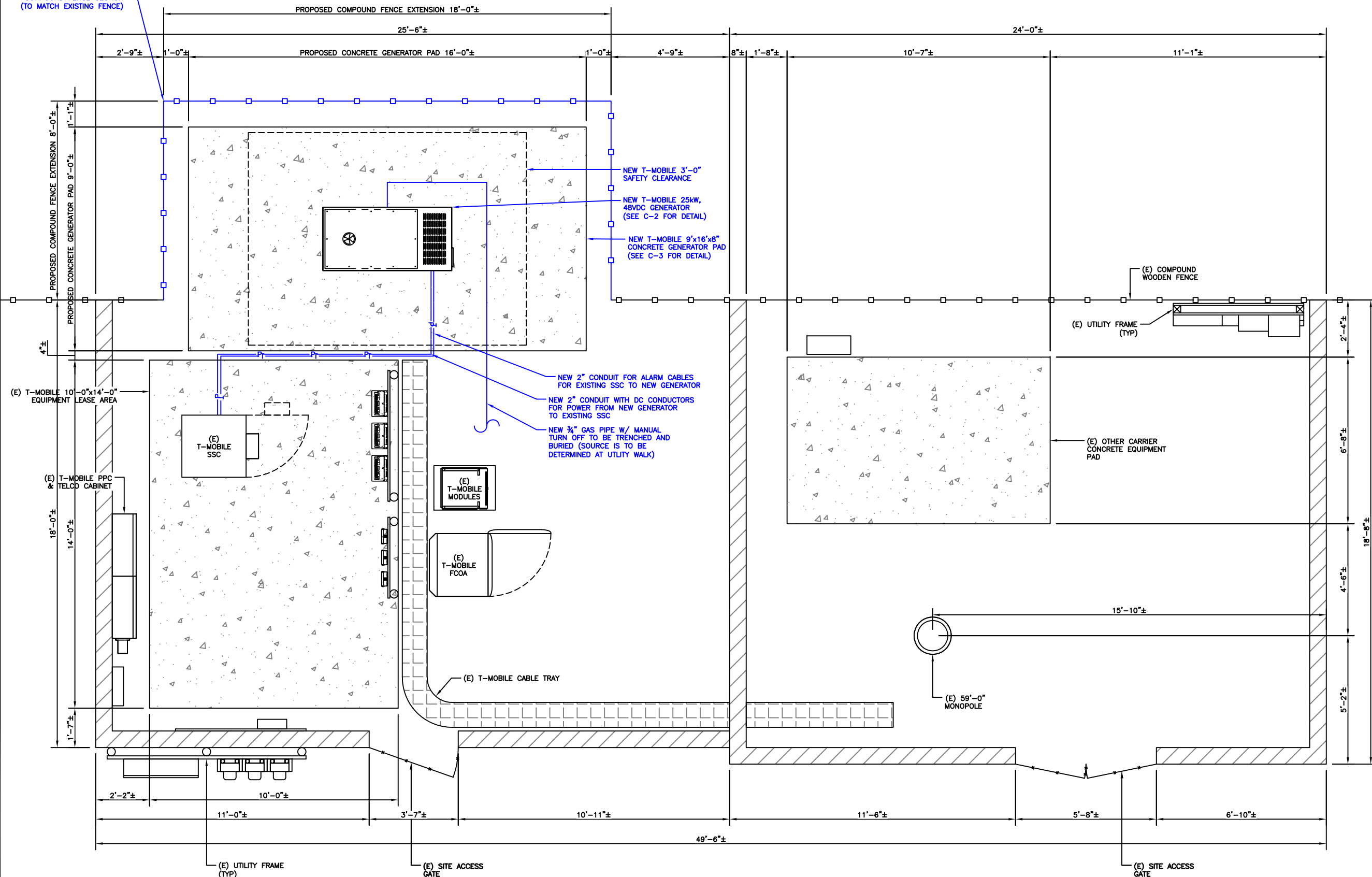

1 SITE PLAN  
SCALE: 1/2"=1'-0" (FULL SIZE)  
1/4"=1'-0" (11x17)



**T-Mobile**

12920 SE 38TH STREET  
BELLEVUE, WA 98006

**BROADUS**  
services

4 COUNTRY PLACE CIRCLE  
DALWORTHINGTON GARDENS  
TEXAS 76016  
OFFICE: (817) 349 3449  
FAX: 800 401 4234

T-MOBILE SITE NUMBER:  
**DN02033C**

BU #: 839586  
**AURORA EAST**

12102 EAST MISSISSIPPI  
AURORA, CO 80012

EXISTING 59'-0" MONOPOLE

**ISSUED FOR:**

REV	DATE	DRWN	DESCRIPTION	DES./QA
A	11/21/2018	JAS	PRELIMINARY	ELG

**THIS DOCUMENT IS  
PRELIMINARY IN  
NATURE AND IS NOT A  
FINAL, SIGNED AND  
SEALED DOCUMENT**

**JACOB GORALSKI, PLLC**  
CONSULTING ENGINEER  
JACOB GORALSKI, PLLC  
CO PE# 0049661  
1106 COLBI ST.  
KENNEDEALE, TX 76060  
(817) 456-2621

IT IS A VIOLATION OF LAW FOR ANY PERSON,  
UNLESS THEY ARE ACTING UNDER THE DIRECTION  
OF A LICENSED PROFESSIONAL ENGINEER,  
TO ALTER THIS DOCUMENT.

SHEET NUMBER:

**C-1**

REVISION:

**A**



T-MOBILE SITE NUMBER:  
DN02033C

BU #: 839586  
AURORA EAST

12102 EAST MISSISSIPPI  
AURORA, CO 80012

EXISTING 59'-0" MONOPOLE

ISSUED FOR:

REV	DATE	DRWN	DESCRIPTION	DES./QA
A	11/21/2018	JAS	PRELIMINARY	ELG

**THIS DOCUMENT IS  
PRELIMINARY IN  
NATURE AND IS NOT A  
FINAL, SIGNED AND  
SEALED DOCUMENT**

JACOB GORALSKI, PLLC  
CONSULTING ENGINEER  
JACOB GORALSKI, PLLC  
CO PE# 0049661  
1106 COLBI ST.  
KENNEDEALE, TX 76060  
(817) 456-2621

IT IS A VIOLATION OF LAW FOR ANY PERSON,  
UNLESS THEY ARE ACTING UNDER THE DIRECTION  
OF A LICENSED PROFESSIONAL ENGINEER,  
TO ALTER THIS DOCUMENT.

SHEET NUMBER:

C-2

REVISION:

A

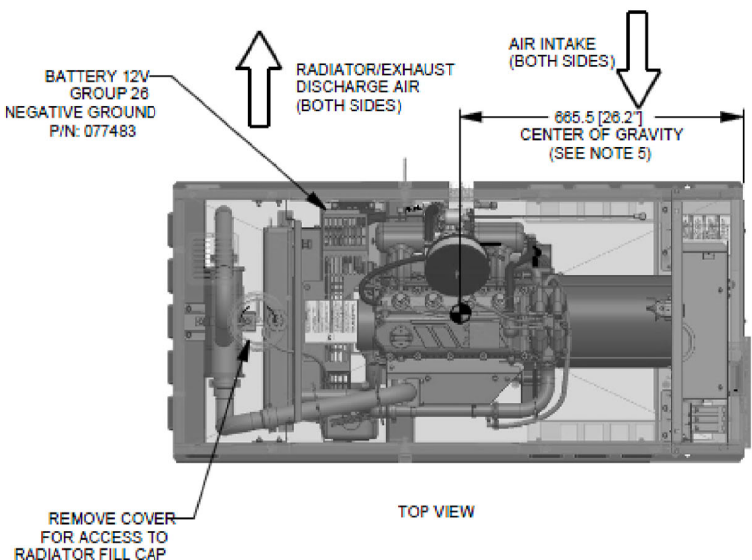

SERVICE ITEM	1.5L
OIL FILL CAP	EITHER DOOR
OIL DIP STICK	RIGHT DOOR
OIL FILTER	RIGHT DOOR
OIL DRAIN HOSE	RIGHT DOOR
RADIATOR DRAIN HOSE	RIGHT DOOR
AIR CLEANER ELEMENT	RIGHT DOOR
SPARK PLUGS	RIGHT DOOR
MUFFLER	SEE NOTE 12
FAN BELT	EITHER DOOR
BATTERY	RIGHT DOOR

REFERENCE OWNERS MANUAL  
FOR PERIODIC  
REPLACEMENT PART LISTINGS.

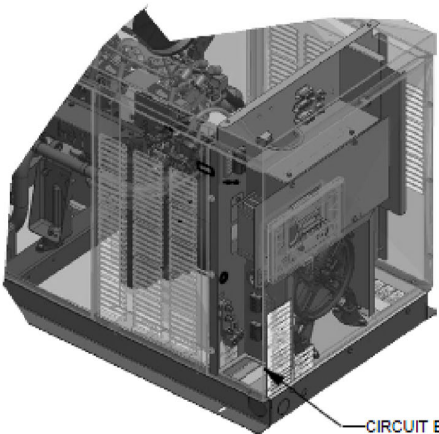

NOTES:

1. MINIMUM RECOMMENDED CONCRETE PAD SIZE: 1092 (43") WIDE X 1887 (74.3") LONG. REFERENCE INSTALLATION GUIDE SUPPLIED WITH UNIT FOR CONCRETE PAD GUIDELINES.
2. ALLOW SUFFICIENT ROOM ON ALL SIDES OF THE GENERATOR FOR MAINTENANCE AND SERVICING. THIS UNIT MUST BE INSTALLED IN ACCORDANCE WITH CURRENT APPLICABLE NFPA 37 AND NFPA 70 STANDARDS AS WELL AS ANY OTHER FEDERAL, STATE, AND LOCAL CODES.
3. CONTROL PANEL / CIRCUIT BREAKER INFORMATION:
  - SEE SPECIFICATION SHEET OR OWNERS MANUAL
  - ACCESSIBLE THROUGH CUSTOMER ACCESS ASSEMBLY DOOR ON REAR OF GENERATOR.
4. REMOVE THE REAR ENCLOSURE COVER PANEL TO ACCESS THE STUB-UP AREAS AS FOLLOWS:
  - HIGH VOLTAGE CONNECTION INCLUDING AC LOAD LEAD CONDUIT CONNECTION
  - NEUTRAL CONNECTION, BATTERY CHARGER 120 VOLT AC (0.5 AMP MAX) CONNECTION.
  - LOW VOLTAGE CONNECTION INCLUDING TRANSFER SWITCH CONTROL WIRES.
5. CENTER OF GRAVITY AND WEIGHT MAY CHANGE DUE TO UNIT OPTIONS.
6. BOTTOM OF GENERATOR SET MUST BE ENCLOSED TO PREVENT PEST INTRUSION AND RECIRCULATION OF DISCHARGE AIR AND/OR IMPROPER COOLING AIR FLOW.
7. EXHAUST SYSTEM MAXIMUM BACK PRESSURE: 24 INCHES H2O.
8. REFERENCE OWNERS MANUAL FOR LIFTING WARNINGS.
9. MOUNTING BOLTS OR STUDS TO MOUNTING SURFACE SHALL BE 5/8-11 GRADE 5 (USE STANDARD SAE TORQUE SPECS)
10. MUST ALLOW FREE FLOW OF INTAKE AIR, DISCHARGE AIR AND EXHAUST. SEE SPEC SHEET FOR MINIMUM AIR FLOW AND MAXIMUM RESTRICTION REQUIREMENTS.
11. GENERATOR MUST BE INSTALLED SUCH THAT FRESH COOLING AIR IS AVAILABLE AND THAT DISCHARGE AIR FROM RADIATOR IS NOT RECIRCULATED.
12. EXHAUST MUFFLER ENCLOSED WITHIN GENERATOR ENCLOSURE, REMOVE ENCLOSURE TO ACCESS EXHAUST MUFFLER.

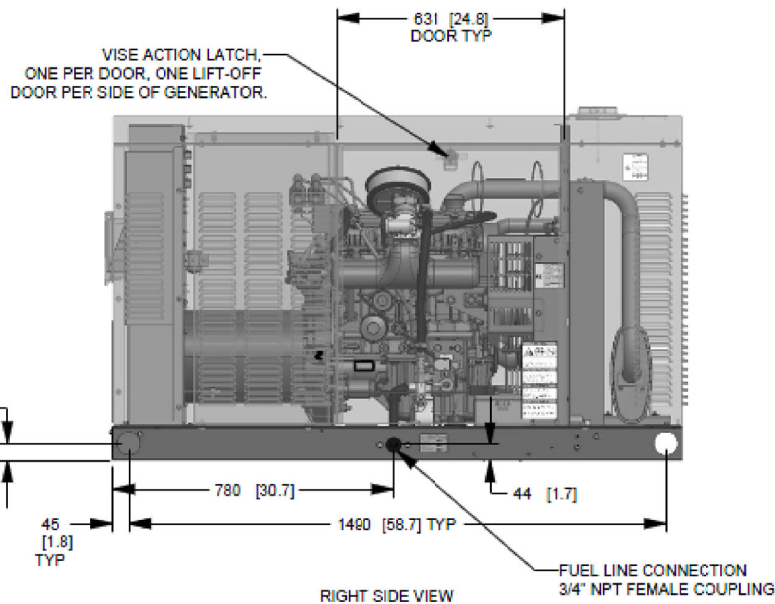
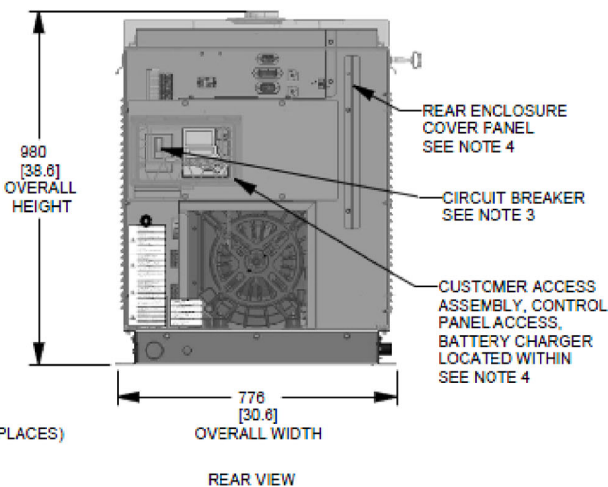
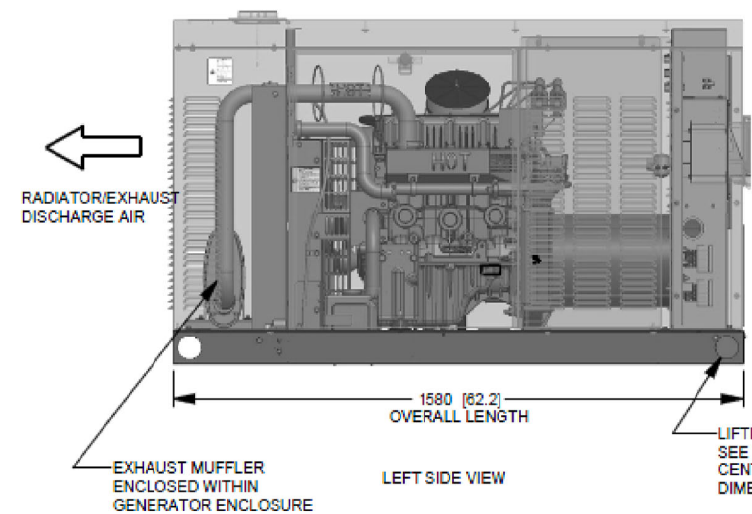

WEIGHT DATA				
ENGINE/KW	ENCLOSURE MATERIAL	WEIGHT GENSET ONLY KG [LBS]	WEIGHT SHIPPING SKID KG [LBS]	SHIPPING WEIGHT KG [LBS]
1.5L/25KW	ST	392 [865]	30 [66]	422 [931]
1.5L/30KW	ST	406 [895]	30 [66]	436 [961]
1.5L/25KW	AL	352 [777]	30 [66]	382 [843]
1.5L/30KW	AL	366 [807]	30 [66]	396 [873]

1 25kW, 48VDC PROPANE GENERATOR (GENERAC RG025)  
SCALE: NOT TO SCALE

REINFORCED CONCRETE NOTES:

- ALL CONCRETE WORK SHALL BE IN ACCORDANCE WITH THE ACI SPECIFICATIONS FOR THE DESIGN AND CONSTRUCTION OF CAST-IN-PLACE CONCRETE, AND WHERE CODES CONFLICT THE MORE STRINGENT NATIONAL OR LOCAL CODE SHALL GOVERN.
- SITECAST CONCRETE FOR SLABS AND POST FOOTING SHALL HAVE A MINIMUM COMPRESSIVE STRENGTH OF 3000 PSI AT 28 DAYS. CONCRETE TESTING IS NOT REQUIRED FOR SLABS AND POST FOOTINGS UNLESS NOTED OTHERWISE.

SLUMP - 4" MIN / 6" MAX

CLASS OF CONCRETE

CLASS	28 DAYS STR.	MAXWATER/CEMENT RATIO	PLACEMENT LOCATION	NOTES
TYPE 1	3000 PSI	0.55	SLAB & POST FOOTING	NORMAL WEIGHT
TYPE 111*	5000 PSI	0.45	SLAB & POST FOOTING	HIGH EARLY STS.

\*IF REQUIRED BY THE CONSTRUCTION SCHEDULE THE CONTRACTOR MAY SUBSTITUTE TYPE 111 HIGH EARLY STRENGTH CONCRETE WITH THE APPROVAL OF THE CONSTRUCTION MANAGER.

- REINFORCED STEEL SHALL CONFORM TO ASTM A 615, GRADE 60, DEFORMED UNLESS NOTED OTHERWISE. WELDED WIRE FABRIC SHALL CONFORM TO ASTM A185 WELDED STEEL WIRE FABRIC UNLESS OTHERWISE NOTED. SPLICES FOR REBAR SHALL BE CLASS "B" AND ALL HOOKS SHALL BE STANDARDS, UNO. LAPS FOR WELDED WIRE FABRIC SHALL BE AT LEAST 8 INCHES, UNO.

- THE FOLLOWING MINIMUM CONCRETE COVER SHALL BE PROVIDED FOR REINFORCING STEEL UNLESS SHOWN OTHERWISE ON DRAWINGS.

CONCRETE CAST AGAINST EARTH.....	3"
CONCRETE EXPOSED TO EARTH OR WATER	
#6 AND LARGER .....	2"
#5 AND SMALLER & wwf .....	1-1/2"

- MAXIMUM COURSE AGGREGATE SIZE SHALL BE 3/4"

- INSTALLATION OF CONCRETE ANCHORS SHALL BE IN ACCORDANCE WITH THE MANUFACTURER'S WRITTEN SPECIFICATION. THE ANCHOR BOLT, DOWEL, OR ROD SHALL CONFORM TO THE ANCHOR MANUFACTURER'S SPECIFICATIONS FOR MATERIAL STRENGTH, EMBEDMENT DEPTH, SPACING, AND EDGE DISTANCE OR AS DETAILED ON THE DRAWINGS. NO REBAR SHALL BE CUT WITHOUT PRIOR ENGINEERING APPROVAL. WHEN DRILLING HOLES IN CONCRETE, EXPANSION BOLTS SHALL BE PROVIDED BY RAMSET/REDHEAD, HILTI, OR APPROVED EQUAL. IF THE MANUFACTURER'S SPECIFICATIONS AND DETAILS ARE FOUND TO CONFLICT WITH THAT SHOWN HEREIN, THE ENGINEER SHALL BE NOTIFIED IMMEDIATELY.

- THE CONTRACTOR SHALL VERIFY FROST LINE AND FOOTING DEPTH REQUIREMENTS WITH THE JURISDICTION HAVING AUTHORITY PRIOR TO CONSTRUCTION AND CONSULT THE ENGINEER ACCORDINGLY.

- THE CONTRACTOR SHALL VERIFY ALL ELECTRICAL CONDUIT SIZES AND PENETRATION LOCATIONS PRIOR TO POURING THE SLAB.

- SOIL SHALL HAVE MINIMUM 1000 PSF ALLOWABLE BEARING CAPACITY.

1 CONCRETE PAD  
SCALE: NOT TO SCALE

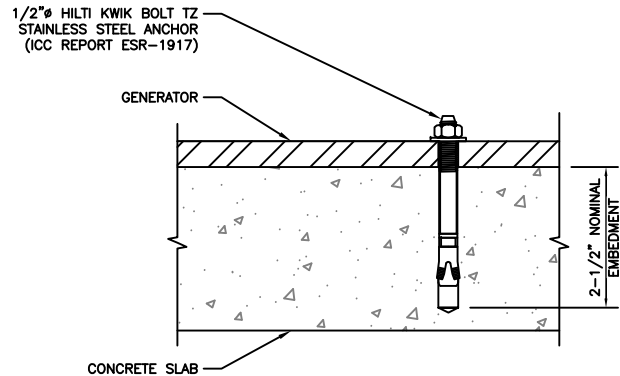
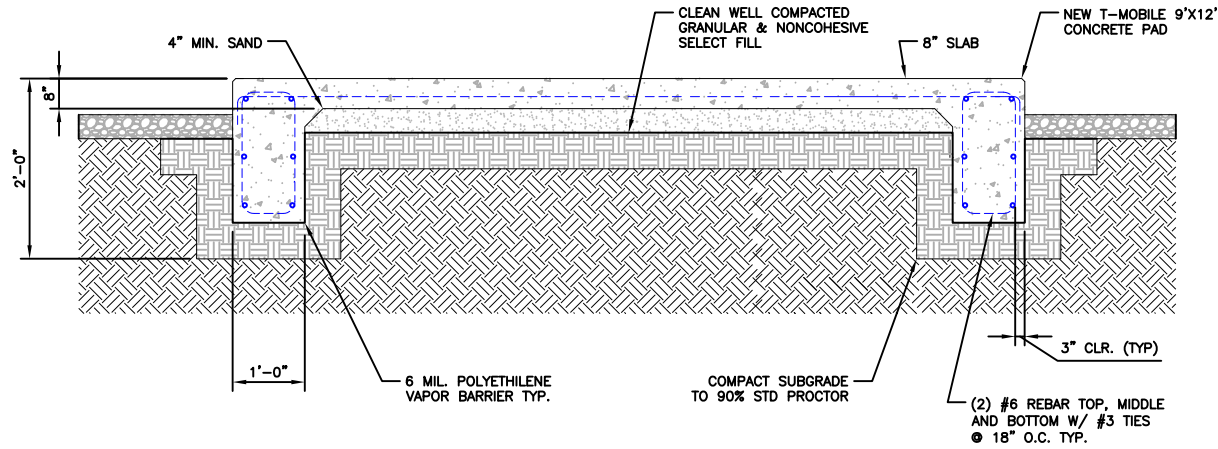
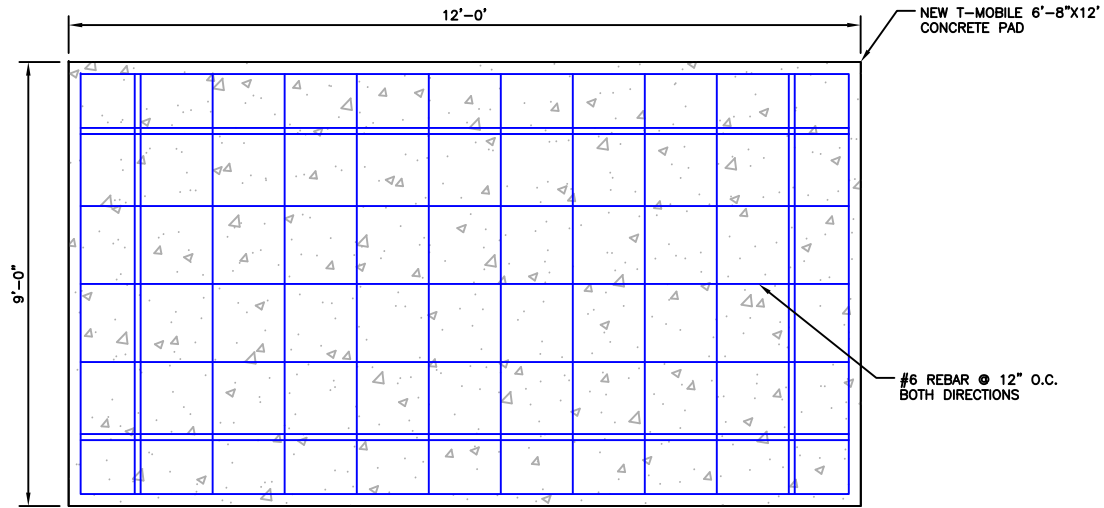

2 ANCHORAGE DETAIL  
SCALE: NOT TO SCALE

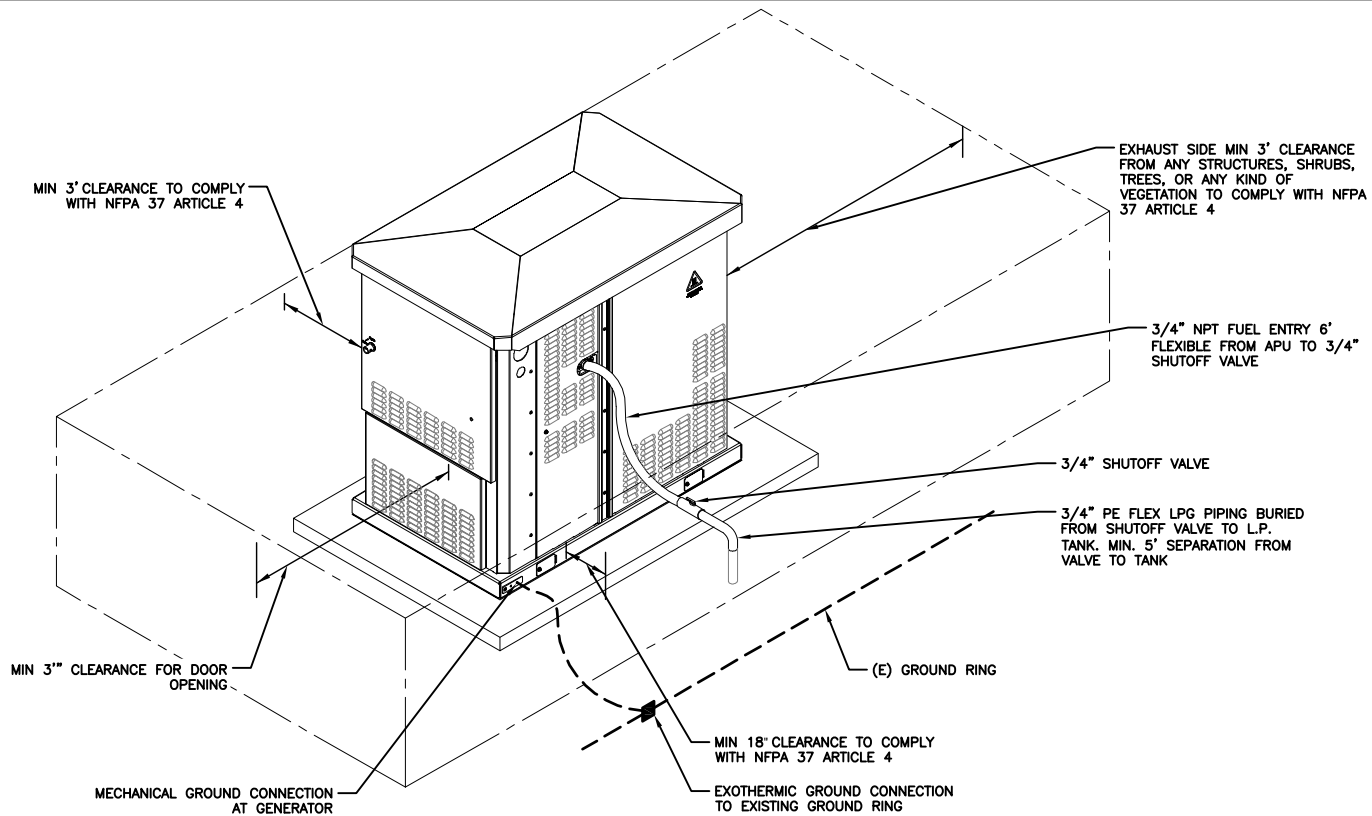

3 UTILITY ENTRY DETAIL  
SCALE: NOT TO SCALE

**T-Mobile**  
12920 SE 38TH STREET  
BELLEVUE, WA 98006

**BROADUS**  
services  
4 COUNTRY PLACE CIRCLE  
DALWORTHINGTON GARDENS  
TEXAS 76016  
OFFICE: (817) 349 3449  
FAX: 800 401 4234

T-MOBILE SITE NUMBER:  
**DN02033C**

BU #: 839586  
**AURORA EAST**

12102 EAST MISSISSIPPI  
AURORA, CO 80012

EXISTING 59'-0" MONOPOLE

ISSUED FOR:

REV	DATE	DRWN	DESCRIPTION	DES./QA
A	11/21/2018	JAS	PRELIMINARY	ELG

**THIS DOCUMENT IS  
PRELIMINARY IN  
NATURE AND IS NOT A  
FINAL, SIGNED AND  
SEALED DOCUMENT**

**JACOB GORALSKI, PLLC**  
CONSULTING ENGINEER  
JACOB GORALSKI, PLLC  
CO PE# 0049661  
1106 COLBI ST.  
KENNEDEALE, TX 76060  
(817) 456-2621

IT IS A VIOLATION OF LAW FOR ANY PERSON,  
UNLESS THEY ARE ACTING UNDER THE DIRECTION  
OF A LICENSED PROFESSIONAL ENGINEER,  
TO ALTER THIS DOCUMENT.

SHEET NUMBER:

**C-3**

REVISION:

**A**



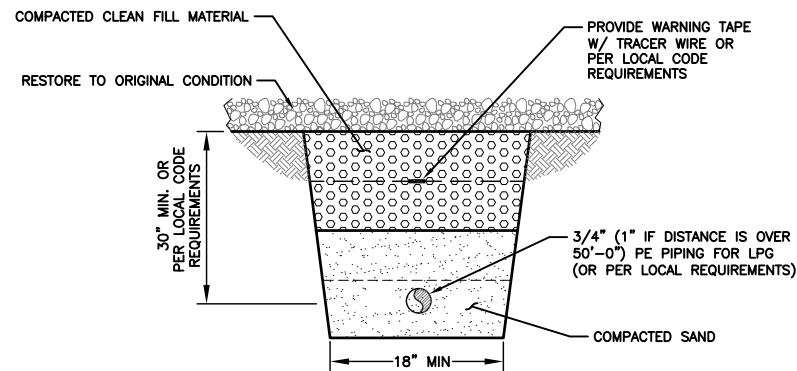

NOTES: TRENCH TO BE HAND DUG AND BEDDING TO BE COMPACTED, PROVIDE CONTINUOUS GRADE, AND FREE OF ROCKS OF DEBRIS.

1 GAS PIPE TRENCH  
SCALE: NOT TO SCALE

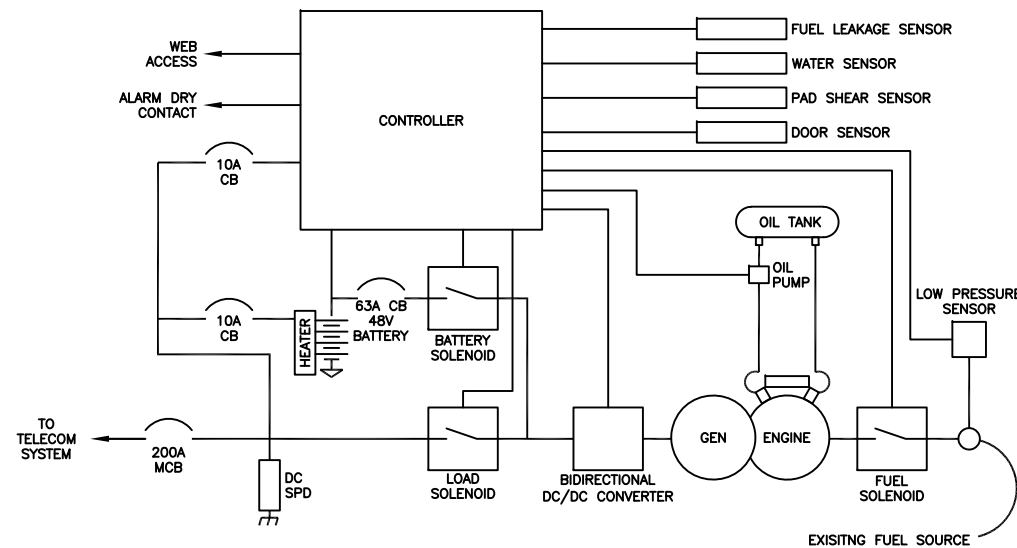

2 DELTA POWERGEN 7500 DC GENSET BLOCK DIAGRAM  
SCALE: NOT TO SCALE

#### AC NORMAL:

UNDER NORMAL CONDITIONS WITH AC POWER TO THE TELECOM CABINET, TELECOM CABINET RECTIFIERS PROVIDE POWER TO LOAD EQUIPMENT AT FLOAT VOLTAGE ABOVE 53V, AND THE GENSET IS NOT RUNNING.

#### AC FAIL:

WHEN AC FAILS, TELECOM CABINET BATTERIES PROVIDE POWER TO LOAD EQUIPMENT, AND BEGIN TO DISCHARGE. WHEN THE TELECOM CABINET BATTERIES DISCHARGE BELOW 48V THE GENSET STARTS AND PROVIDES POWER TO LOAD AND POWER TO RECHARGE THE TELECOM CABINET BATTERIES TO 52V. GENSET OUTPUT IS ACTIVELY LIMITED TO PREVENT BATTERY RECHARGE OVERCURRENT.

#### AC RECOVERY:

WHEN AC RECOVERS, TELECOM CABINET RECTIFIERS RESUME PROVIDING POWER TO LOAD EQUIPMENT AND RECHARGE THE TELECOM CABINET BATTERIES A FLOAT VOLTAGE ABOVE 53V AND THE GENSET GOES TO NO OUTPUT. WHEN VOLTAGE GOES ABOVE 53V THE GENSET COOLS DOWN AND SHUTS DOWN.

3 DELTA POWERGEN 7500 DC GENSET OPERATING MODES  
SCALE: NOT TO SCALE

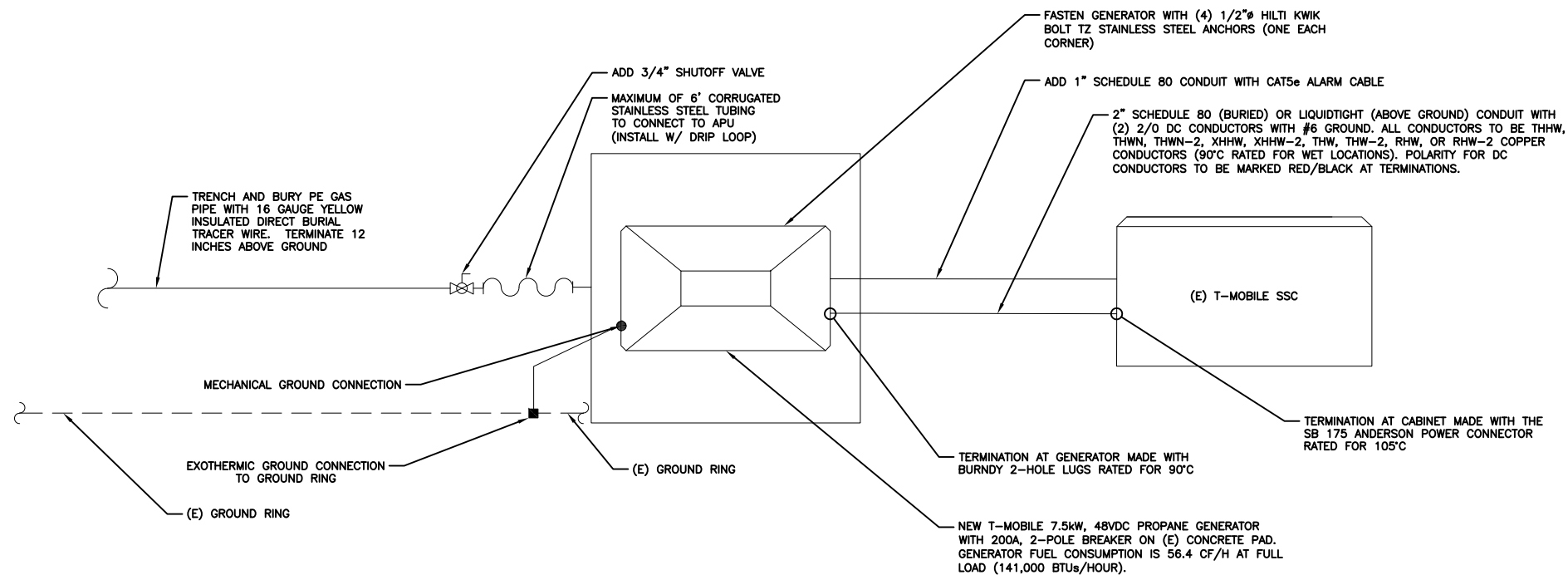

3 48VDC PROPANE GENERATOR ONE LINE DIAGRAM  
SCALE: NOT TO SCALE

**T-Mobile**

12920 SE 38TH STREET  
BELLEVUE, WA 98006

**BROADUS**  
services

4 COUNTRY PLACE CIRCLE  
DALWORTHINGTON GARDENS  
TEXAS 76016  
OFFICE: (817) 349 3449  
FAX: 800 401 4234

T-MOBILE SITE NUMBER:  
**DN02033C**

BU #: **839586**  
**AURORA EAST**

12102 EAST MISSISSIPPI  
AURORA, CO 80012

EXISTING 59'-0" MONOPOLE

#### ISSUED FOR:

REV	DATE	DRWN	DESCRIPTION	DES./QA
A	11/21/2018	JAS	PRELIMINARY	ELG

**THIS DOCUMENT IS  
PRELIMINARY IN  
NATURE AND IS NOT A  
FINAL, SIGNED AND  
SEALED DOCUMENT**

**JACOB GORALSKI, PLLC**  
CONSULTING ENGINEER  
JACOB GORALSKI, PLLC  
CO PE# 0049661  
1106 COLBI ST.  
KENNEDEALE, TX 76060  
(817) 456-2621

IT IS A VIOLATION OF LAW FOR ANY PERSON,  
UNLESS THEY ARE ACTING UNDER THE DIRECTION  
OF A LICENSED PROFESSIONAL ENGINEER,  
TO ALTER THIS DOCUMENT.

SHEET NUMBER:

**C-4**

REVISION:

**A**

SIGNAGE REQUIREMENTS:

1. STORAGE CONTAINER MUST HAVE A DATAPLATE. (PROVIDED BY TANK MANUFACTURER DURING TANK FABRICATION)  
NFPA 58:5.2.8.3
2. STORAGE CONTAINER MUST BE MARKED DESCRIBING THE CONTENTS (PROPANE OR LIQUEFIED PRETROLEUM GAS) AND A STATEMENT OF THE HAZARD (FLAMMABLE).  
NFPA 1:60.1.13 & IFC:2703.5
3. STORAGE CONTAINER MUST BE MARKED WITH HAZMAT ID. (CERTAIN ENTRANCES TO STORAGE OR DISPENSING AREAS MAY ALSO REQUIRE HAZMAT ID MARKING)  
NFPA 1:60.1.13, NFPA 704:1.3 & IFC:2703.5
4. NO SMOKING SIGNS MUST BE POSTED IN AREAS OR SITES WHERE FLAMMABLE GASES ARE USED OR STORED. NO SMOKING OR OPEN FLAMES WITHIN 25 FT. OF POINT OF TRANSFER.  
NFPA 1:60.1.13, IFC:3807.2, IFC:2703.7, & NFPA 58:7.2.3.2(B)
5. THE MAXIMUM PERMITTED PERCENTAGE (%) OF TANK CAPACITY MUST BE MARKED EITHER ON THE DATAPLATE OR ADJACENT TO THE FIXED MAXIMUM LIQUID LEVEL GAUGE.  
NFPA 58:5.7.5.4

1 SIGNAGE REQUIREMENTS  
SCALE: NOT TO SCALE

PROPANE

2 PROPANE SIGN  
SCALE: NOT TO SCALE

FLAMMABLE

3 FLAMMABLE SIGN  
SCALE: NOT TO SCALE

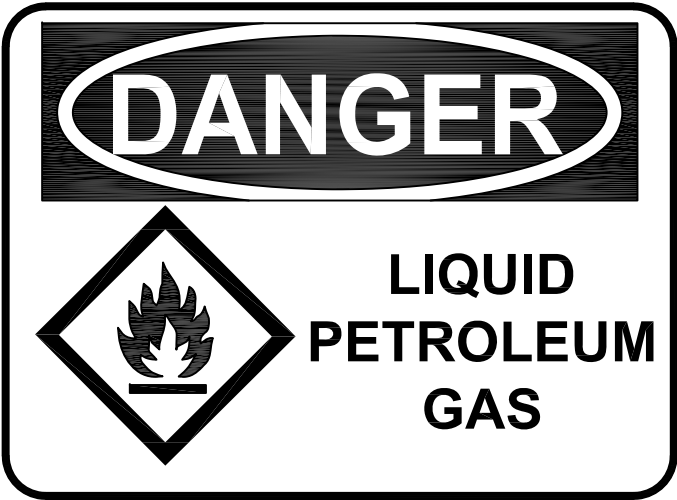

4 LIQUID PETROLEUM GAS  
SCALE: NOT TO SCALE

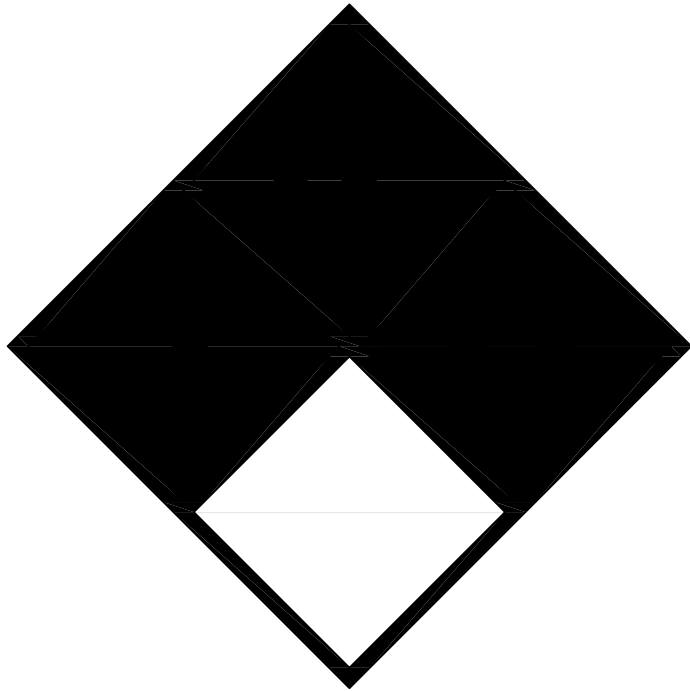

5 HAZARD LEVEL INDICATOR SIGN  
SCALE: NOT TO SCALE



6 NO SMOKING SIGN  
SCALE: NOT TO SCALE

**T-Mobile**  
12920 SE 38TH STREET  
BELLEVUE, WA 98006

**BROADUS**  
services  
4 COUNTRY PLACE CIRCLE  
DALWORTHINGTON GARDENS  
TEXAS 76016  
OFFICE: (817) 349 3449  
FAX: 800 401 4234

T-MOBILE SITE NUMBER:  
**DN02033C**

BU #: **839586**  
**AURORA EAST**

12102 EAST MISSISSIPPI  
AURORA, CO 80012

EXISTING 59'-0" MONOPOLE

ISSUED FOR:

REV	DATE	DRWN	DESCRIPTION	DES./QA
A	11/21/2018	JAS	PRELIMINARY	ELG

**THIS DOCUMENT IS  
PRELIMINARY IN  
NATURE AND IS NOT A  
FINAL, SIGNED AND  
SEALED DOCUMENT**

**JACOB GORALSKI, PLLC**  
CONSULTING ENGINEER  
JACOB GORALSKI, PLLC  
CO PE# 0049661  
1106 COLBI ST.  
KENNEDEALE, TX 76060  
(817) 456-2621

IT IS A VIOLATION OF LAW FOR ANY PERSON,  
UNLESS THEY ARE ACTING UNDER THE DIRECTION  
OF A LICENSED PROFESSIONAL ENGINEER,  
TO ALTER THIS DOCUMENT.

SHEET NUMBER:

**C-5**

REVISION:

**A**