

SHIFT STATS
OFFICE SHIFT - 0800-1700 ~10 EMPLOYEES
WAREHOUSE SHIFT #1 - 1700-0130 ~13 EMPLOYEES ~75 DRIVERS
WAREHOUSE SHIFT #2 - 0200-1030 ~23 EMPLOYEES ~75 DRIVERS

LEGEND
←→ TRACTOR TRAILER PRIMARY ROUTE
←→ TRACTOR TRAILER SECONDARY ROUTE
←- - - - - AUTO PRIMARY ROUTE
←- - - - - POSSIBLE FREIGHT ROUTES

# MAIN ENTRANCE AND EXIT

WAREHOUSE TRAFFIC  
1700-1030  
OFFICE TRAFFIC  
0800-1700

EMERGENCY  
ENTRANCE AND  
EXIT ONLY

ENTRANCE AND  
EXIT NOT USED

SMITH RD.

AIRPORT BLVD.

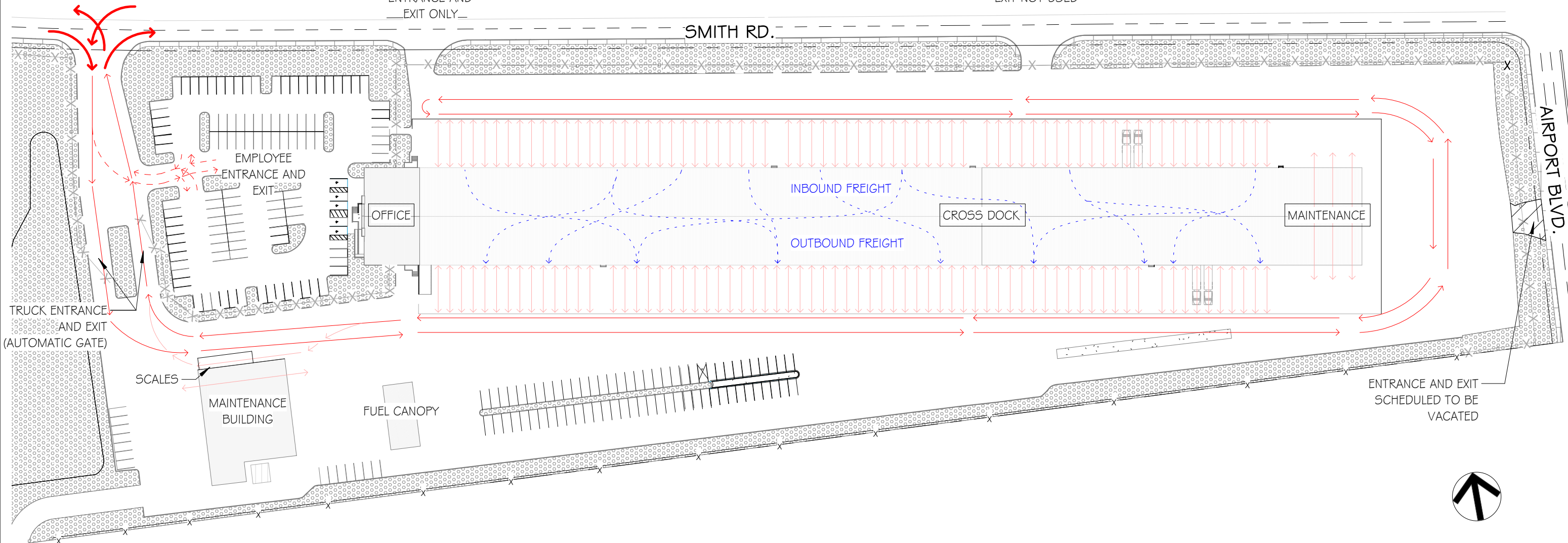

## 1 SITE PLAN OPERATIONS PLAN 1.4 SCALE: 1" = 100'-0"